

LINEA ROSSA®

LR6100
KATLANIR KAPI SİSTEMİ

TEKNİK ÖZELLİKLER TECHNICAL PROPERTIES

- Kasa Derinliği : 57 mm.
- Kasa Yükseklik : 56,5 - 47 mm.
- Kanat Genişlik : 49 mm.
- Profil Kalınlık : 1,4 - 1,8 mm.
- Max. Cam Kalınlığı : 26 mm.
- Hammadde : EN AW 6060-T66, EN AW 6063 T5 (EN 573-3)
- Özgül Ağırlık : 2,71 gr/cm³
- Kopma, Akma Mukavem. : 215 N/mm² - 160 N/mm² (EN 755-2)
- Uzama : %8 (EN 755-2)
- Sertlik : 70 HRB
- Elektrostatik Boya : 60 Mikron min. (Qualicoat)
- Eloksal : 8-10-12-15-20 Mikron (Qualanod)
- Üretim Ölçü Toleransları : EN 12020-2, EN 755-9

- *Frame Width* : 57 mm.
- *Frame Height* : 56,5 - 47 mm.
- *Sash Width* : 49 mm.
- *Profile Thickness* : 1,4 - 1,8 mm.
- *Max.Glass Thickness* : 26 mm.
- *Material* : EN AW 6060-T66, EN AW 6063 T5 (EN 573-3)
- *Specific Gravity* : 2,71 gr/cm³
- *Yield, Flow Strength* : 215 N/mm² - 160 N/mm² (EN 755-2)
- *Elongation* : %8 (EN 755-2)
- *Hardness* : 70 HRB
- *Pow. Coating Standarts* : 60 Mikron min. (Qualicoat)
- *Anodizing Oxidation Stan.* : 8-10-12-15-20 Mikron (Qualanod)
- *Measurement Tol. Stand.* : EN 12020-2, EN 755-9

LINEA ROSSA®

LR6100
KATLANIR KAPI SİSTEMİ

INDEX



Profil
Profile

Profil Kodu
Profile Nr

Ağırlık (kg/m.)
Weight (kg/m.)

X mm.

Y mm.

Jx cm⁴

Jy cm⁴

Sayfa
Page

	LR-6101	1,595	57	56,5	25,65	13,61	
	LR-6102	0,990	57	47	16,34	4,72	
	LR-6103	1,210	49	70,7	12,79	20,22	
	LR-6104	0,221	20,7	20,1	0,00	0,00	
	LR-6105	0,5100	76,3	21,5	7,27	0,92	
	LR-6110	0,126	13,7	6,7	
	LR-6111	0,830	49	32,5	8,29	1,25	
	LR-6112	1,302	49	71	13,22	22,99	
	LR-6131	0,405	45,8	18,8	



Profil
Profile

Profil Kodu
Profile Nr

Ağırlık (kg/m.)
Weight (kg/m.)

X mm.

Y mm.

Jx cm⁴

Jy cm⁴

Sayfa
Page

Profil Profile	Profil Kodu Profile Nr	Ağırlık (kg/m.) Weight (kg/m.)	X mm.	Y mm.	Jx cm ⁴	Jy cm ⁴	Sayfa Page
	LR-4131	0,306	29,7	24,6	
	LR-4132	0,226	17,6	24,6	
	LR-4133	0,290	25,2	24,6	
	LR-4134	0,264	21,7	24,6	
	LR-4135	0,246	17,7	24,6	
	LR-5132	0,319	33,7	24,6	

LINEA ROSSA®

LR6100
KATLANIR KAPI SİSTEMİ

PROFİLLER PROFILES

PH Plastik Hizalama
Plastic Corner Alignment

KH Krom Hizalama
Chrome Corner Alignment

DB Dik Bağlantı
Transom-Mullion Cleat

AK Adaptör Kapağı
Adapter Cap

PT Pres Takoz
Corner Cleat Profile

VT Vidalı Takoz
Corner Spring

Kertme
Notching

Takoz Punch
Manual Punch

Köşe Pres
Press Tool

Testere
Saw

Hızlı Yapıştırıcı
Adhesive

Slikon
Sealant

Tokmak
Mallet

Falçata
Curved Knife

Ambalaj Miktarı
Packing Unit

Delik Çapı
Drilling Jig

Yalıtım Bantı
Insulation Tape

Üst Ray Profili -

LR-6101

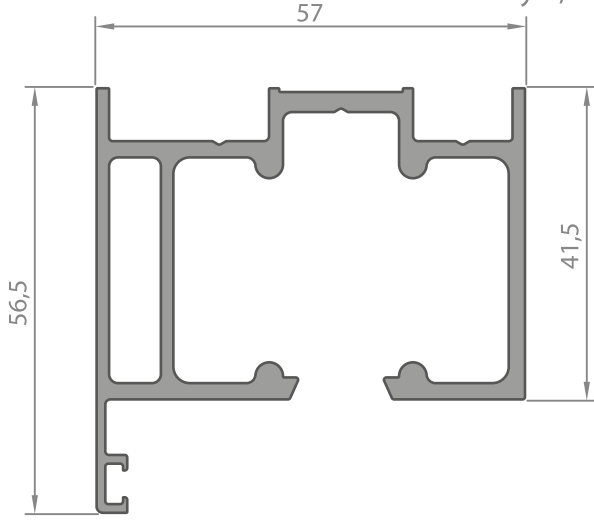
1,595 Kg/m
Jx:0,00 cm⁴
Jy:0,00 cm⁴

90° Kanat Profili - Sliding Sash Profile

Yan Kasa Profili -

LR-6102

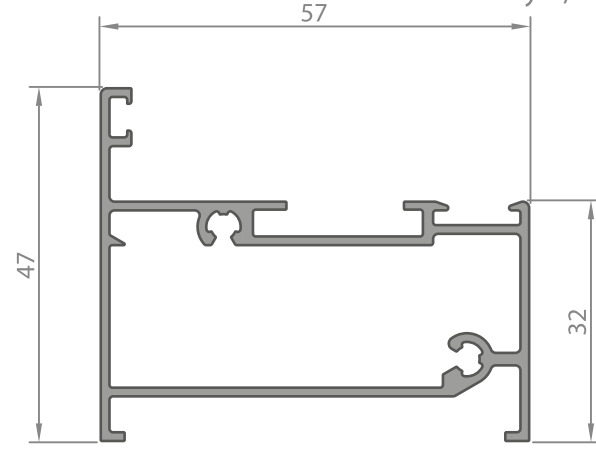
0,990 Kg/m
Jx:0,00 cm⁴
Jy:0,00 cm⁴

90° Kanat Profili - Sliding Sash Profile

LR-6112

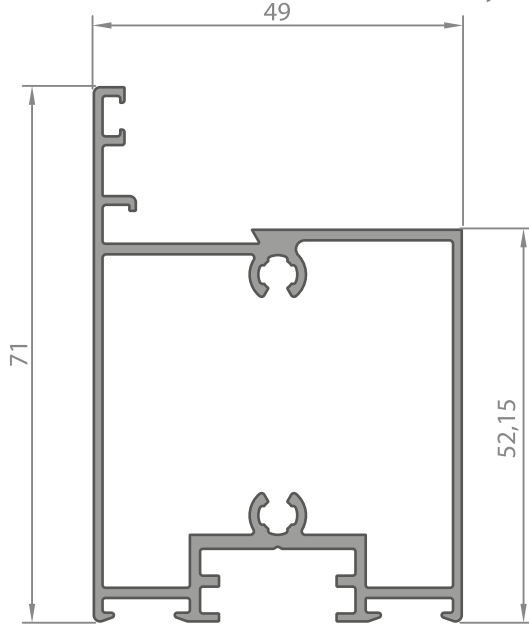
1,302 Kg/m
Jx:0,00 cm⁴
Jy:0,00 cm⁴

Tırnak Profili - Sliding Sash Profile

LR-6104

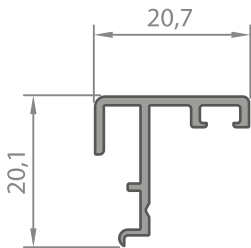
0,221 Kg/m
Jx:0,00 cm⁴
Jy:0,00 cm⁴

LR-6111

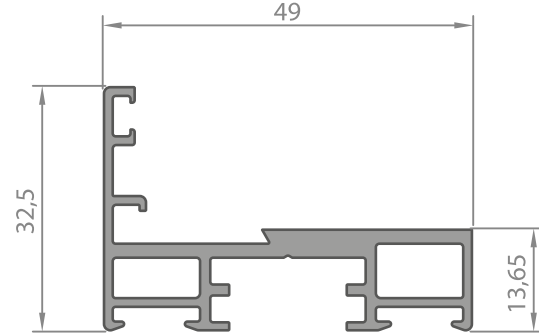
0,830 Kg/m
Jx:0,00 cm⁴
Jy:0,00 cm⁴

Alt Klavuz Profili - Clamped Profile

LR-6105

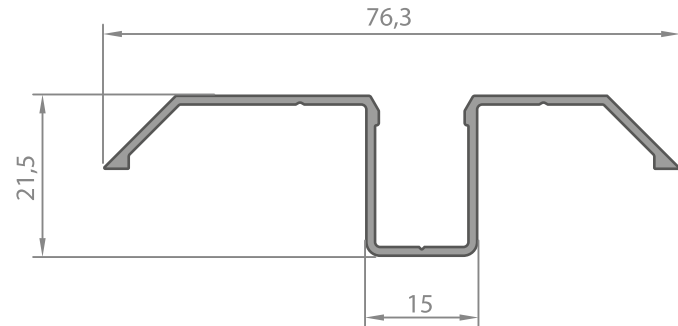
0,510 Kg/m
Jx:0,00 cm⁴
Jy:0,00 cm⁴

45° Kanat Profili - Sliding Sash Profile

LR-6103

1,210 Kg/m
Jx:0,00 cm⁴
Jy:0,00 cm⁴

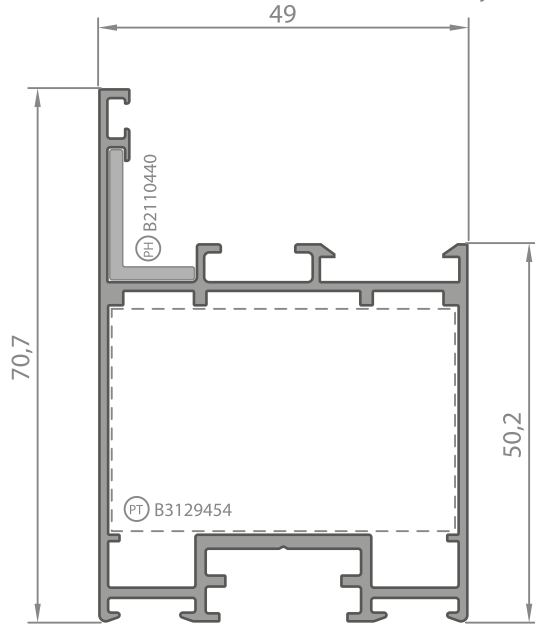

Alt Fital Profili - Clamped Profile

LR-6110

0,126 Kg/m
Jx:0,00 cm⁴
Jy:0,00 cm⁴

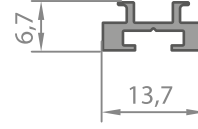

Cam Çıta Profili - Glazing Bead Profile (LR6111-LR6112)

LR-6131

0,405 Kg/m
Jx:0,00 cm⁴
Jy:0,00 cm⁴

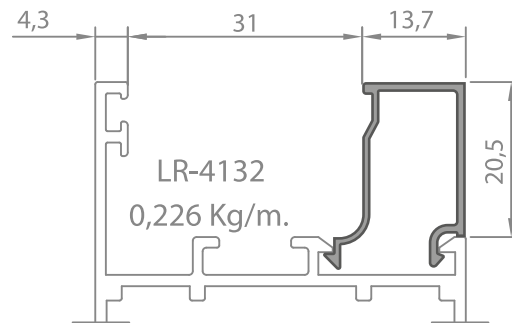
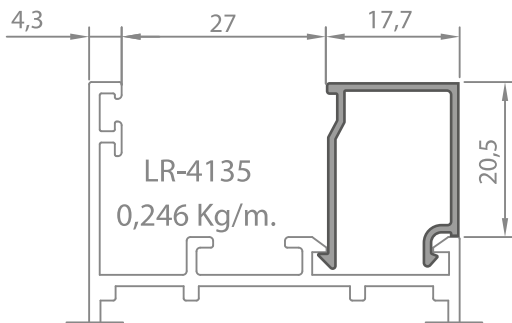
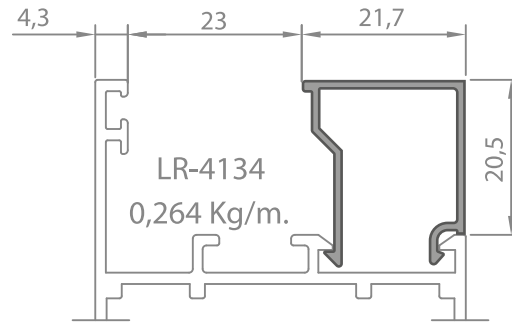
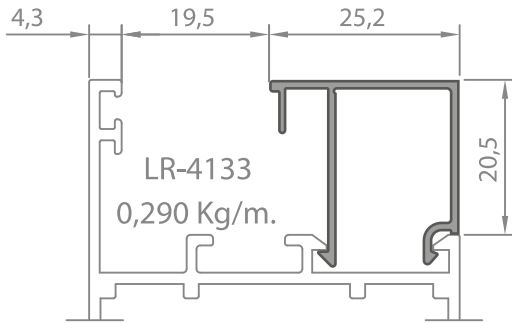
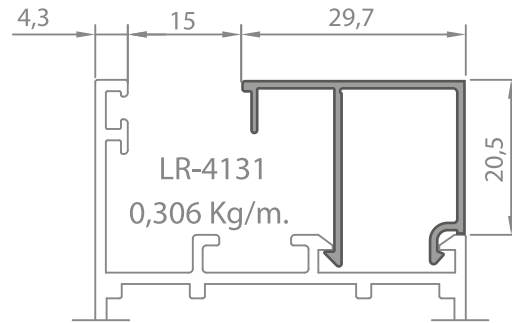
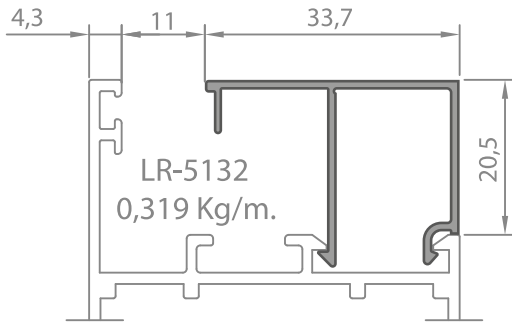
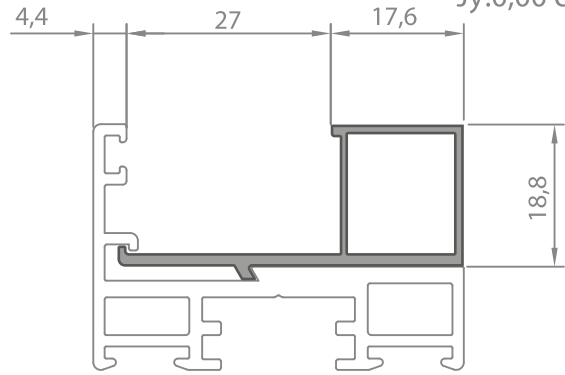

LINEA ROSSA®

LR6100
KATLANIR KAPI SİSTEMİ

KESİT DETAYLAR DETAILS

PH Plastik Hizalama
Plastic Corner Alignment

KH Krom Hizalama
Chrome Corner Alignment

DB Dik Bağlantı
Transom-Mullion Cleat

AK Adaptör Kapağı
Adapter Cap

PT Pres Takoz
Corner Cleat Profile

VT Vidalı Takoz
Corner Spring

Kertme
Notching

Takoz Punch
Manual Punch

Köşe Pres
Press Tool

Testere
Saw

Hızlı Yapıştırıcı
Adhesive

Slikon
Sealant

Tokmak
Mallet

Falçata
Curved Knife

Ambalaj Miktarı
Packing Unit

Delik Çapı
Drilling Jig

Yalıtım Bantı
Insulation Tape

ÖLÇEK:1:1
SCALE:1:1

45° Kanat Açılım Tipleri

45° Types of Opening

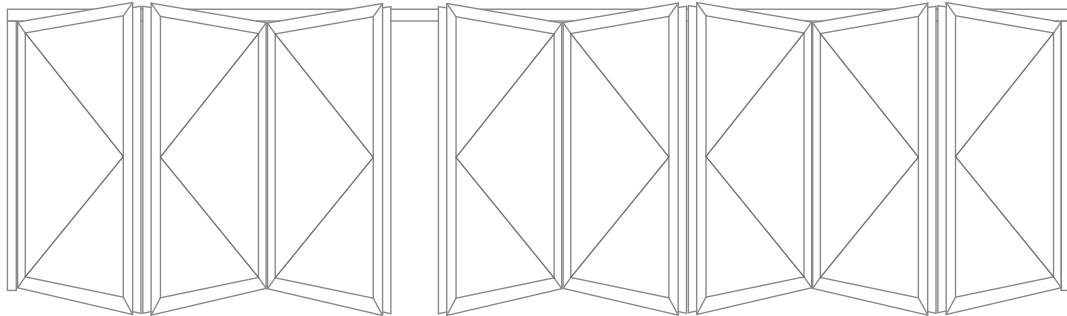
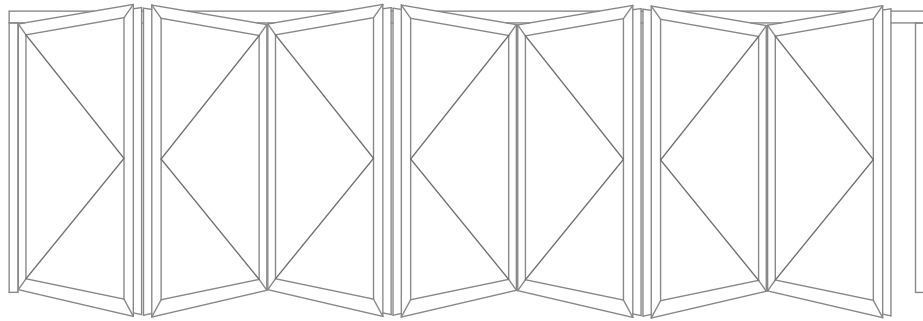
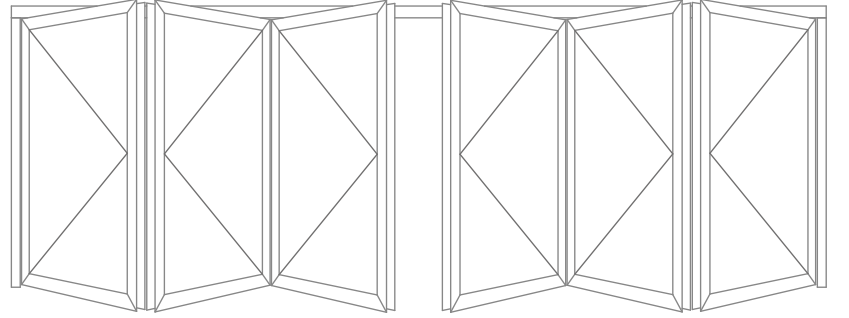
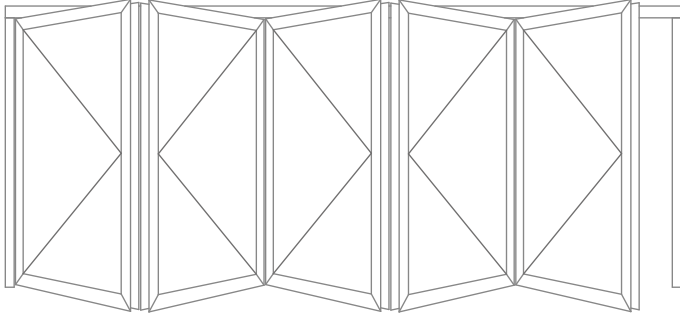
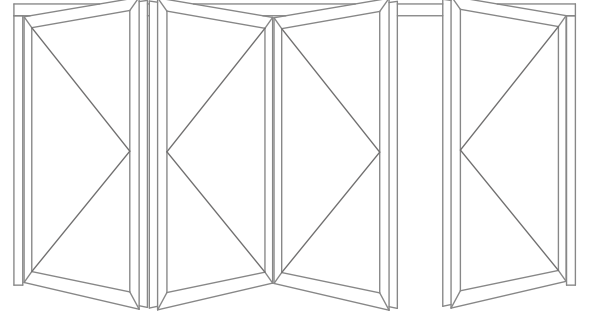
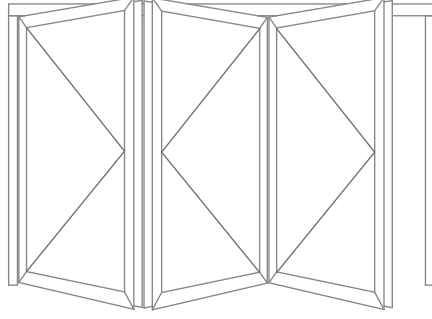
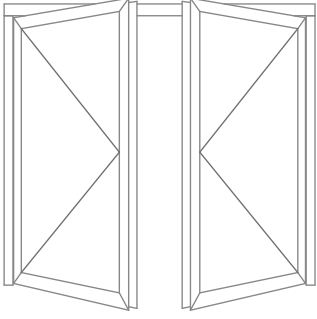

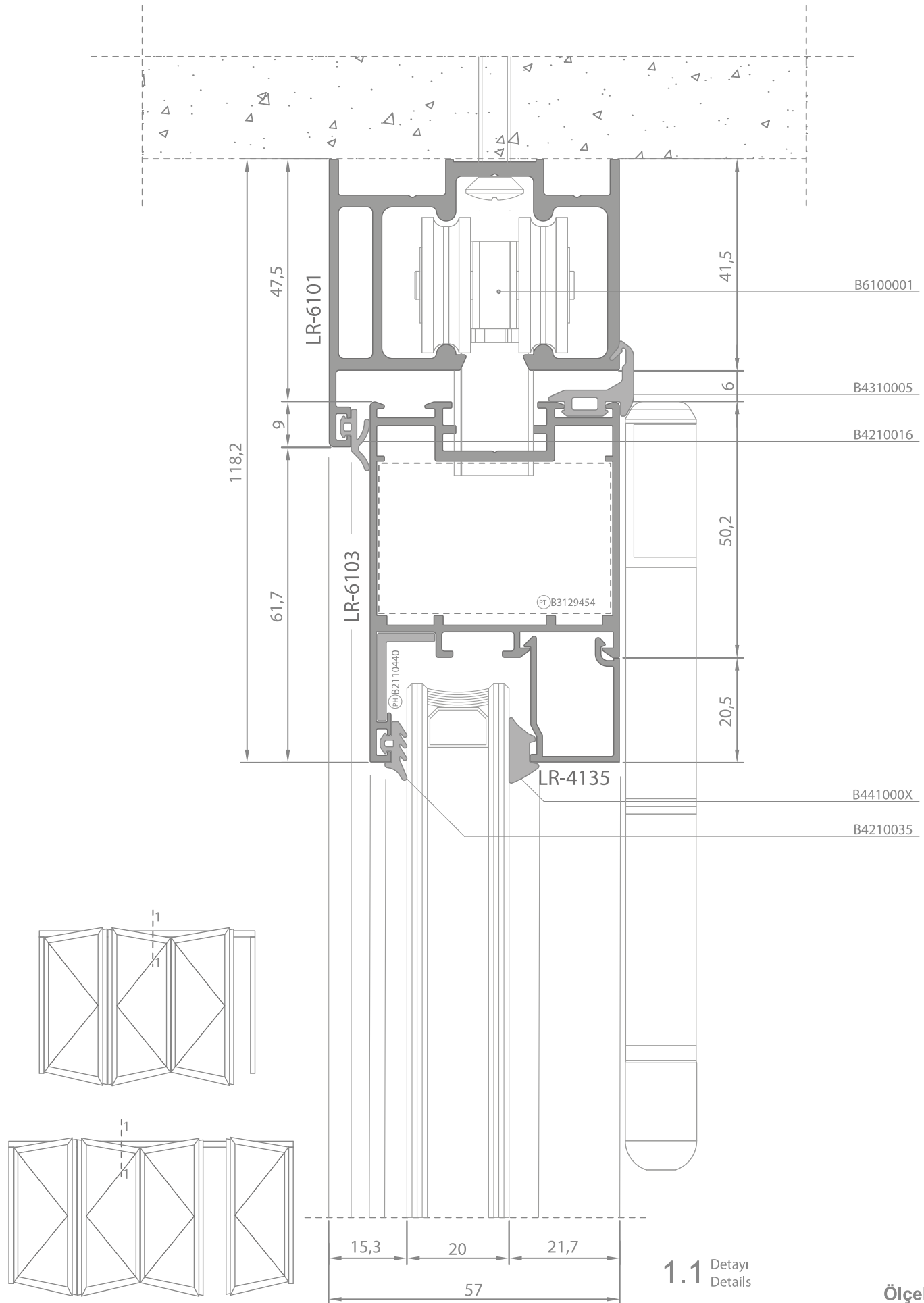

Ölçek: 1:1
Scale: 1:1

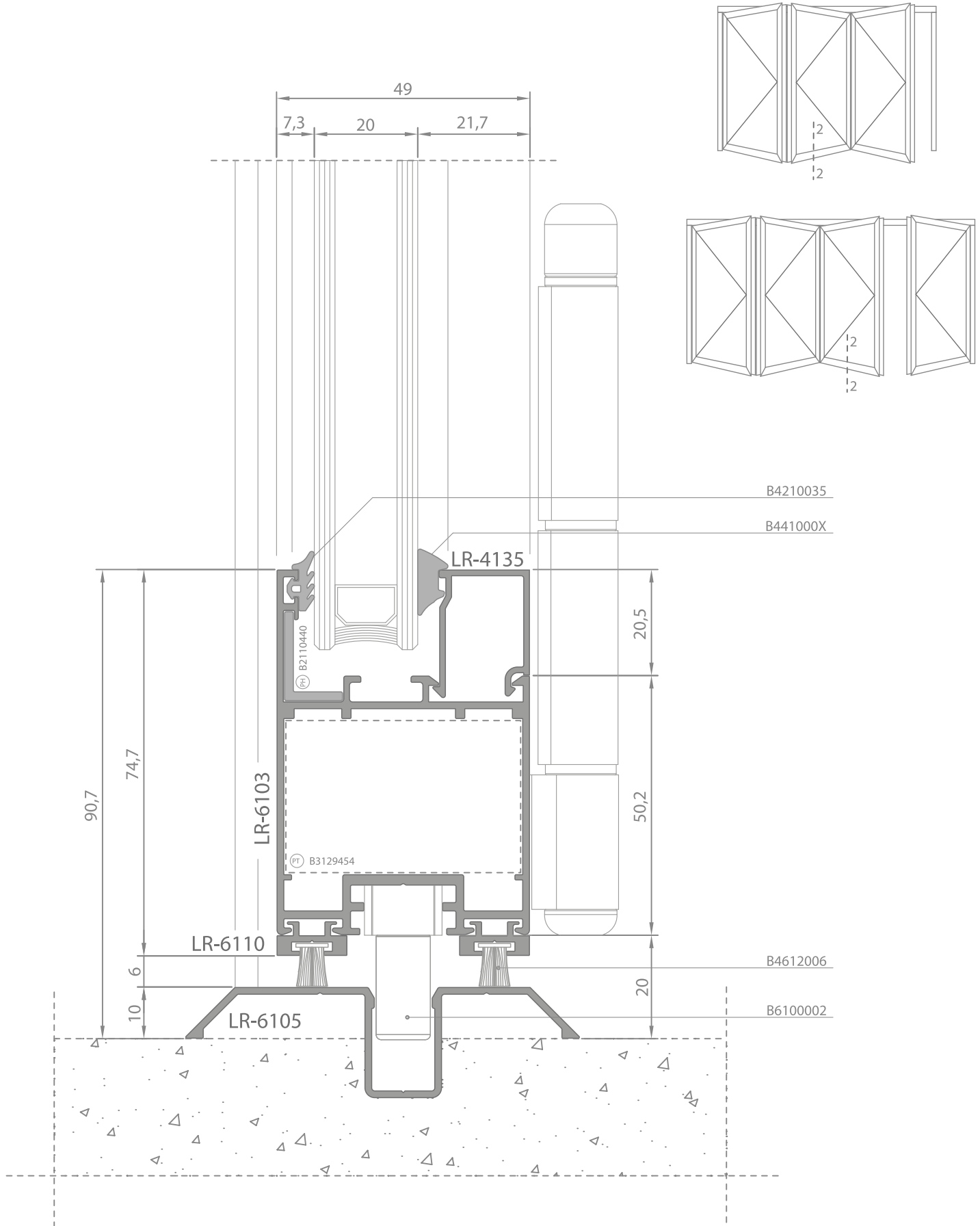

2.2 Detayı Details

LR6100 serisinin tüm fikri ve sınai hakları tescillidir, kopyalanamaz. / All intellectual and industrial property rights of LR6100 series are copyrighted.

Profil ağırlıklarımız teorik ağırlıklardır, üretim sonrası tartı ağırlığı geçerli olacaktır. / The weight values of profiles are theoretical. Weighting after production is valid.

Ölçek: 1:1
Scale: 1:1

SAYFA 00

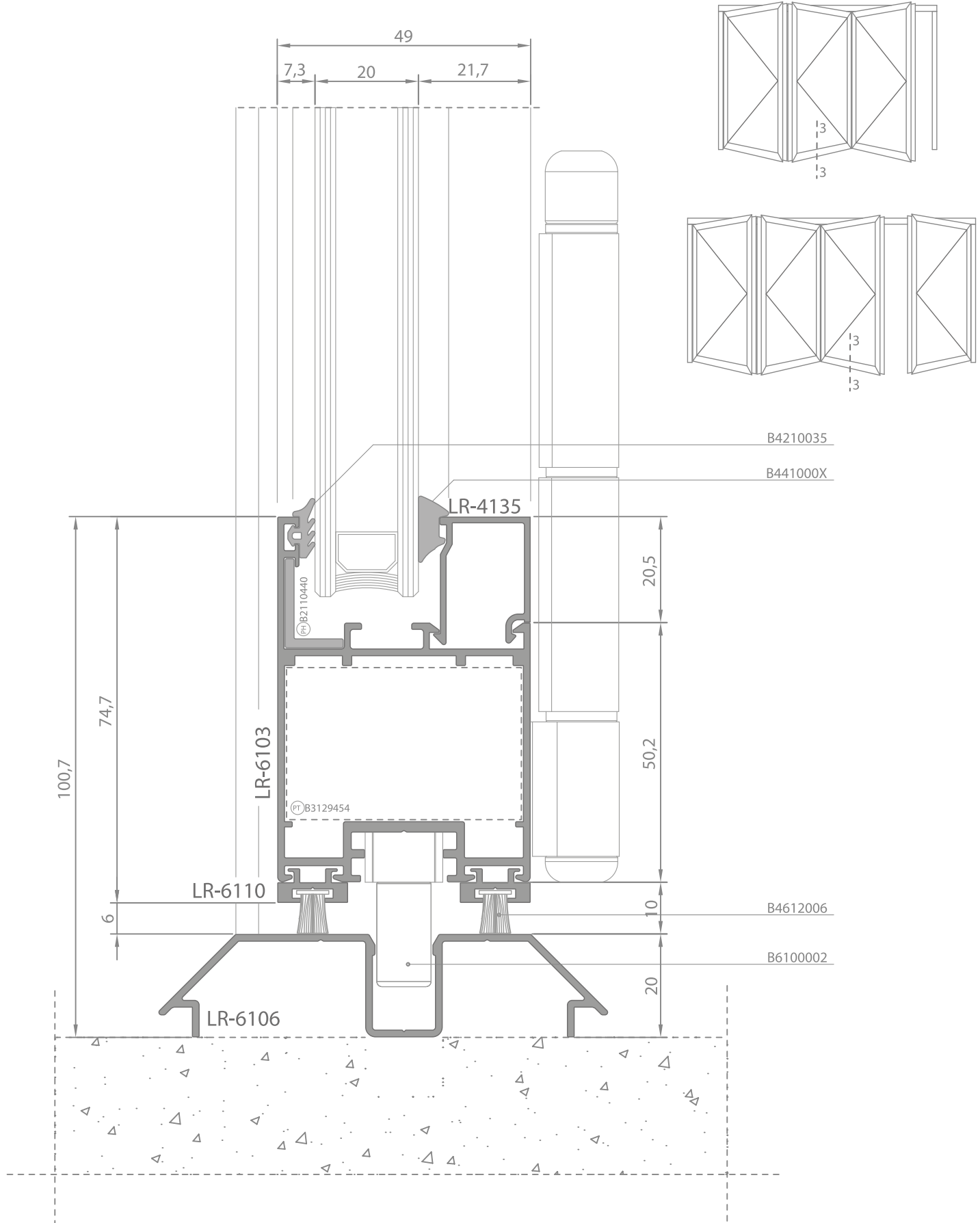

3.3 Detayı Details

LR6100 serisinin tüm fikri ve sınai hakları tescillidir, kopyalanamaz. / All intellectual and industrial property rights of LR6100 series are copyrighted.

Profil ağırlıklarımız teorik ağırlıklardır, üretim sonrası tartı ağırlığı geçerli olacaktır. / The weight values of profiles are theoretical. Weighting after production is valid.

Ölçek: 1:1
Scale: 1:1

SAYFA 00

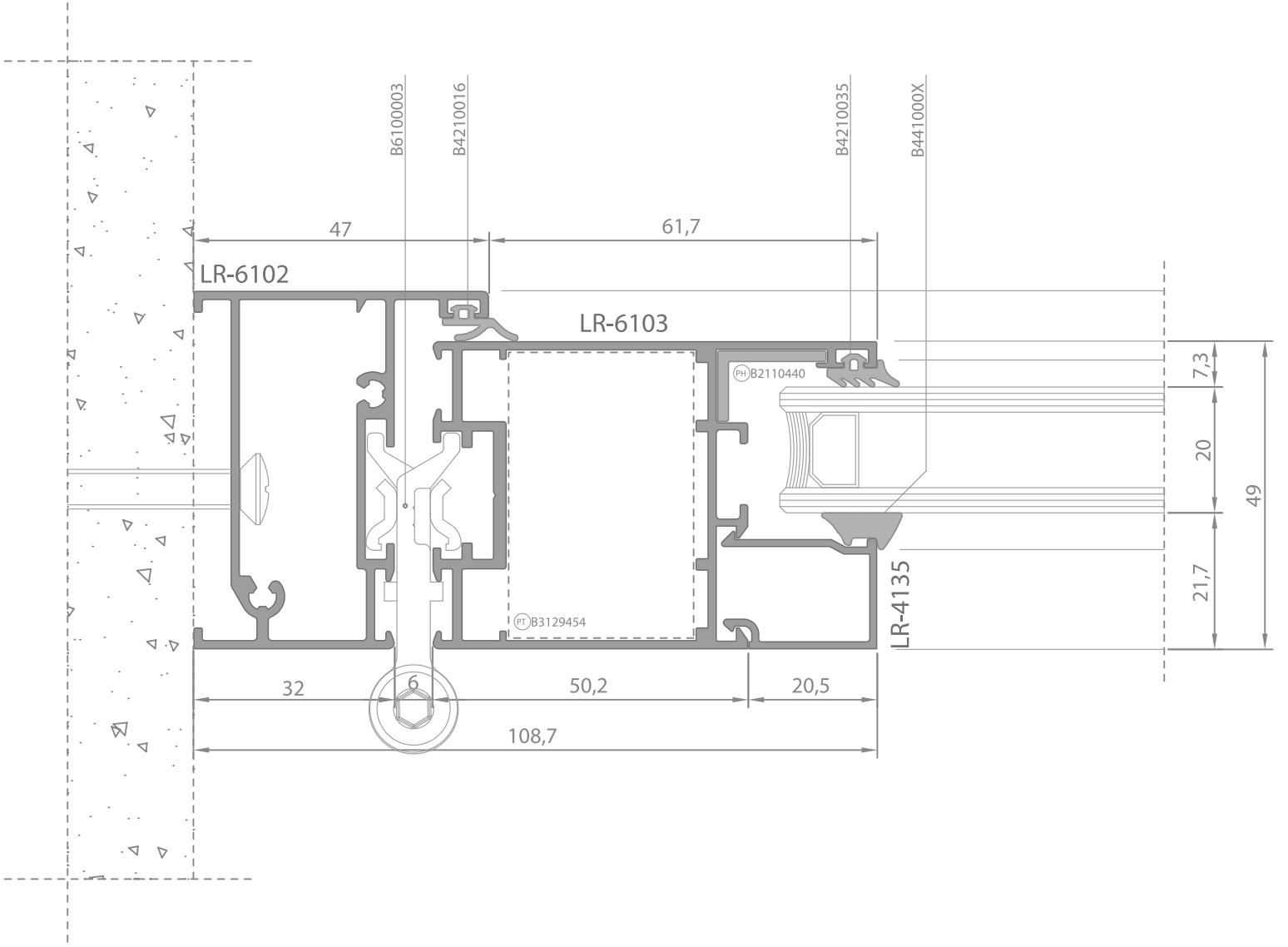
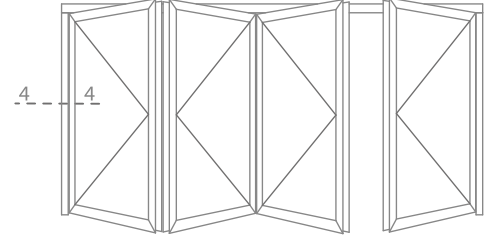
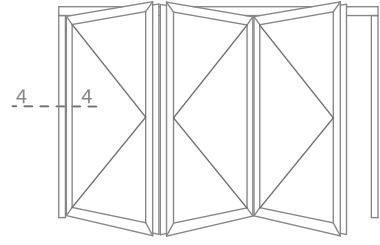

4.4 Detayı Details

Ölçek: 1:1
Scale: 1:1

LR6100 serisinin tüm fikri ve sınai hakları tescillidir, kopyalanamaz. / All intellectual and industrial property rights of LR6100 series are copyrighted.

Profil ağırlıklarımız teorik ağırlıklardır, üretim sonrası tartı ağırlığı geçerli olacaktır. / The weight values of profiles are theoretical. Weighting after production is valid.

SAYFA 00

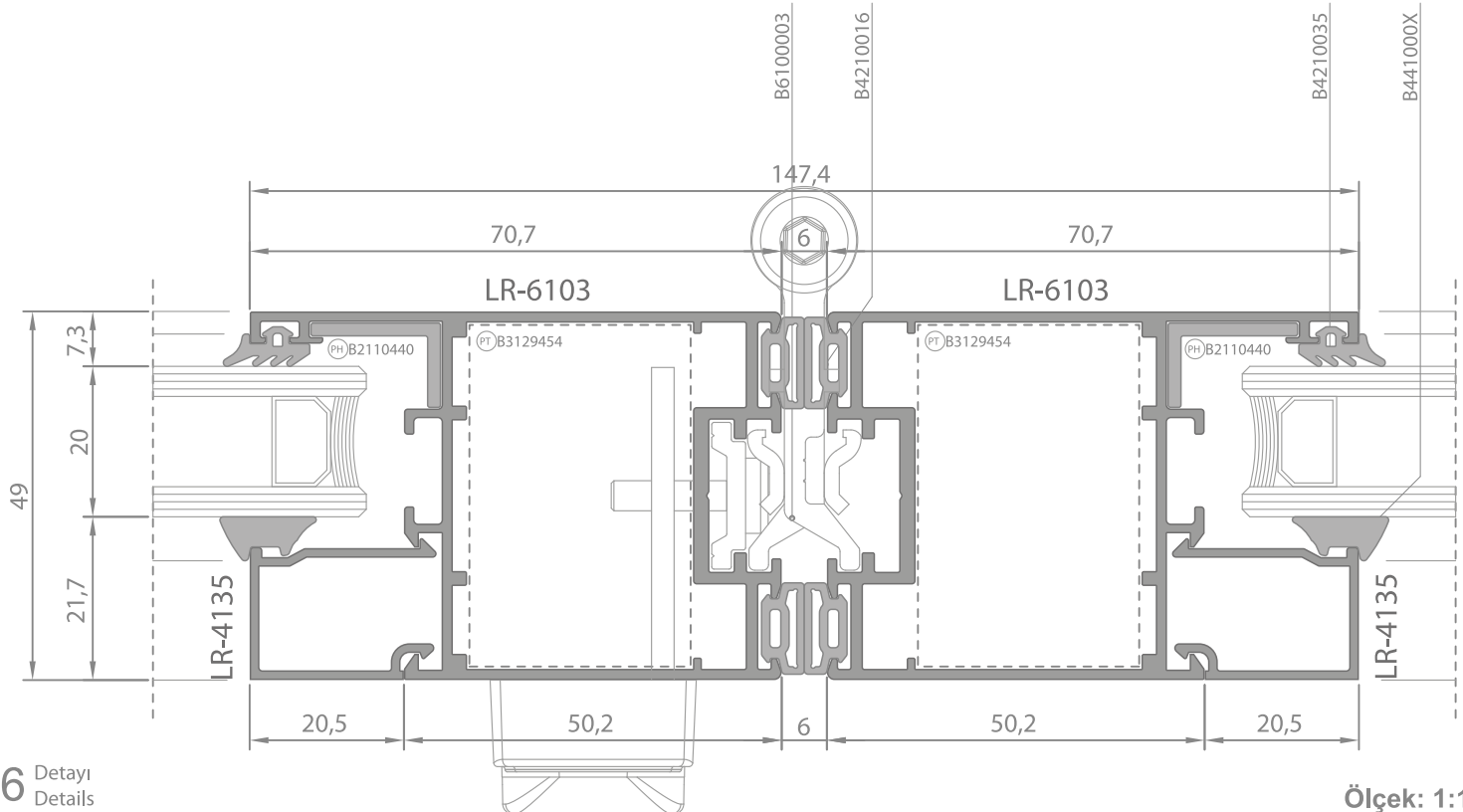
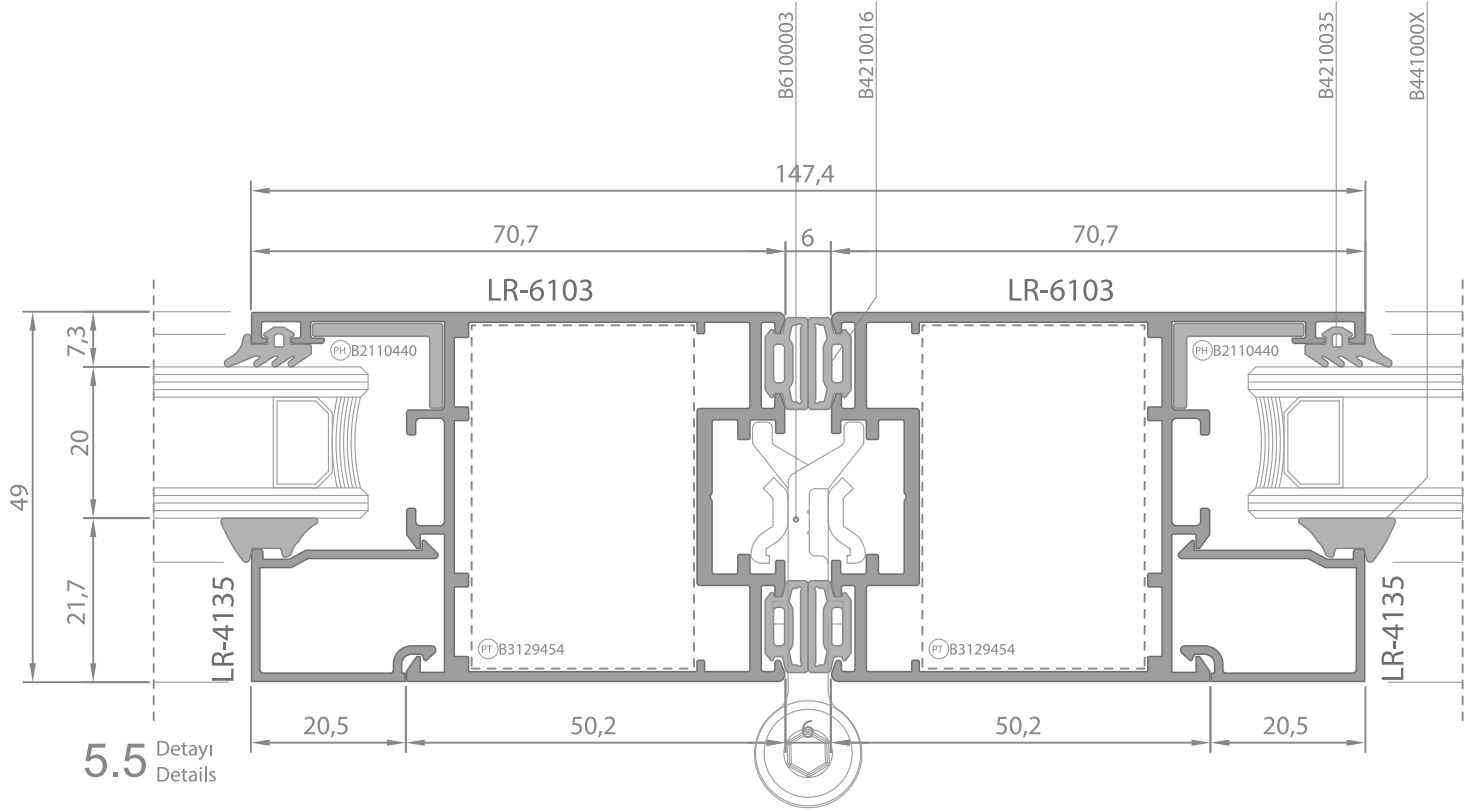
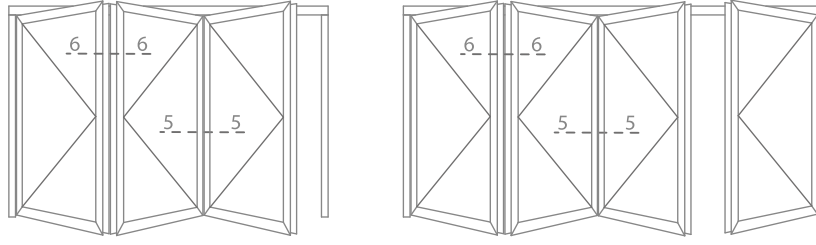

Ölçek: 1:1
Scale: 1:1

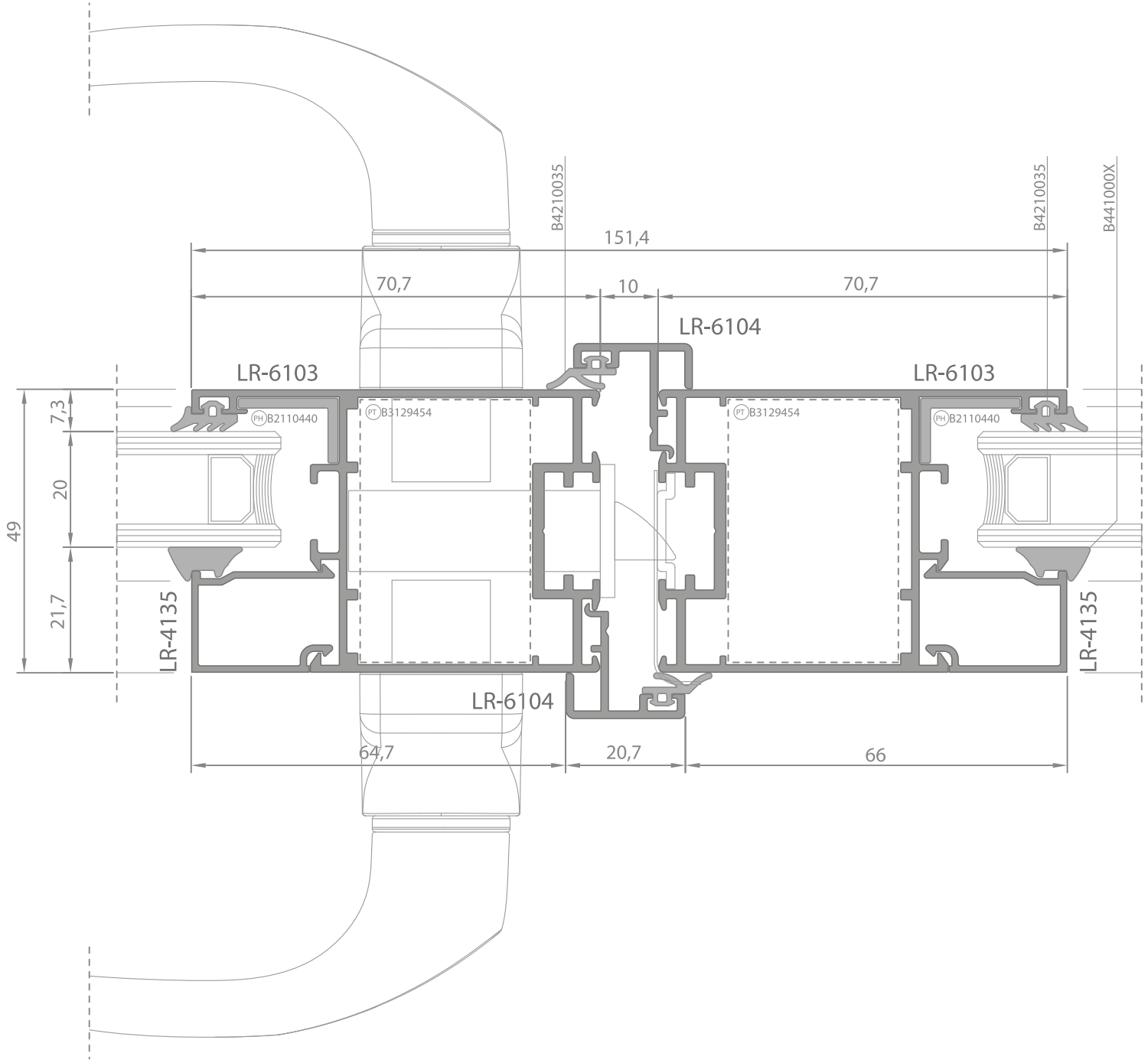
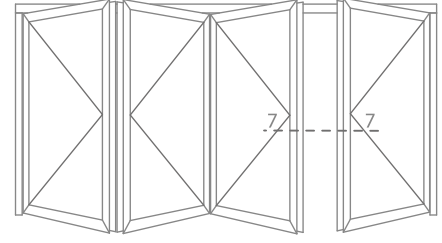

7.7 Detay Details

Ölçek: 1:1
Scale: 1:1

LR6100 serisinin tüm fikri ve sınai hakları tescillidir, kopyalanamaz. / All intellectual and industrial property rights of LR6100 series are copyrighted.

Profil ağırlıklarımız teorik ağırlıklardır, üretim sonrası tartı ağırlığı geçerli olacaktır. / The weight values of profiles are theoretical. Weighting after production is valid.

SAYFA 00

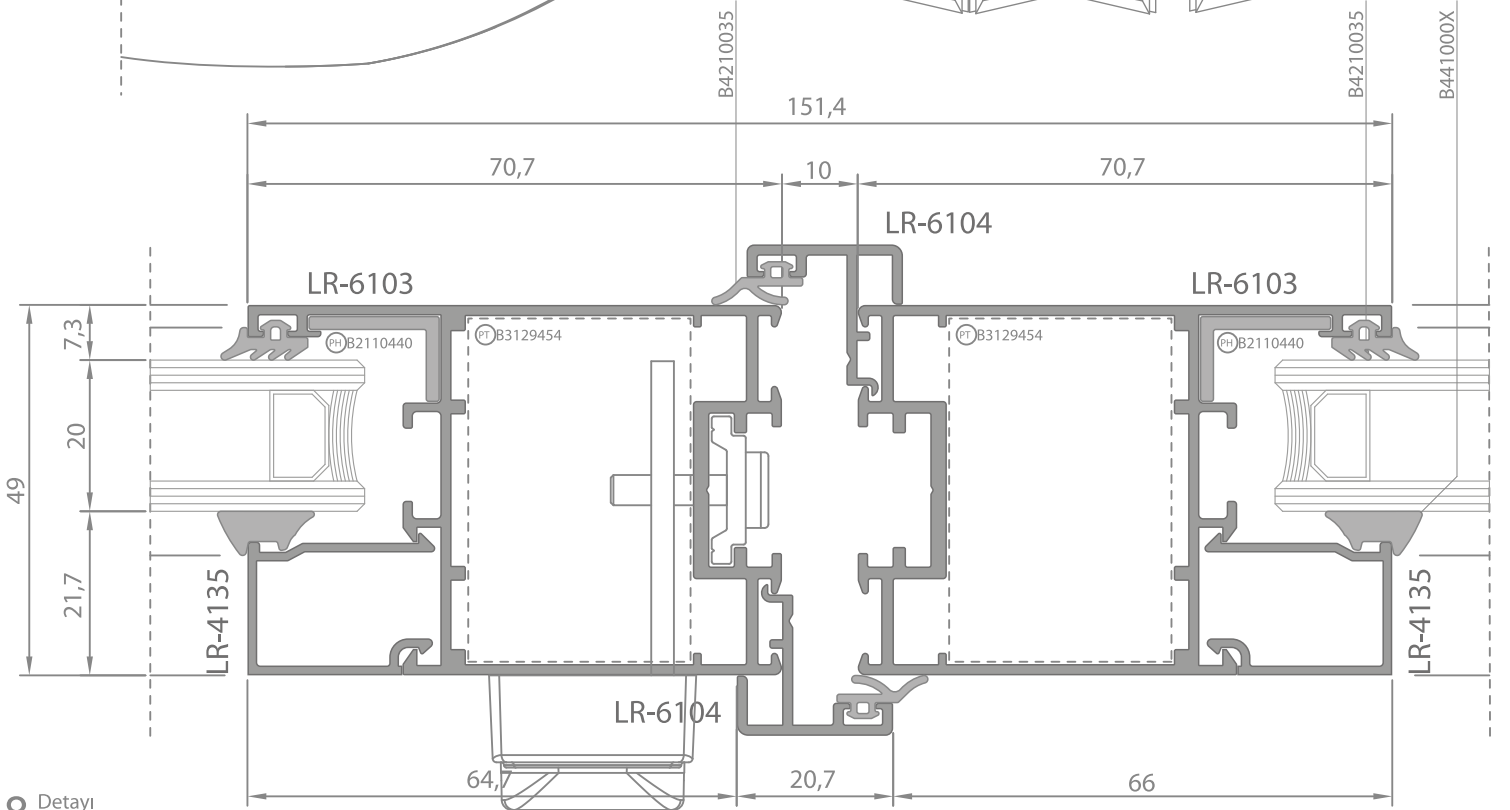
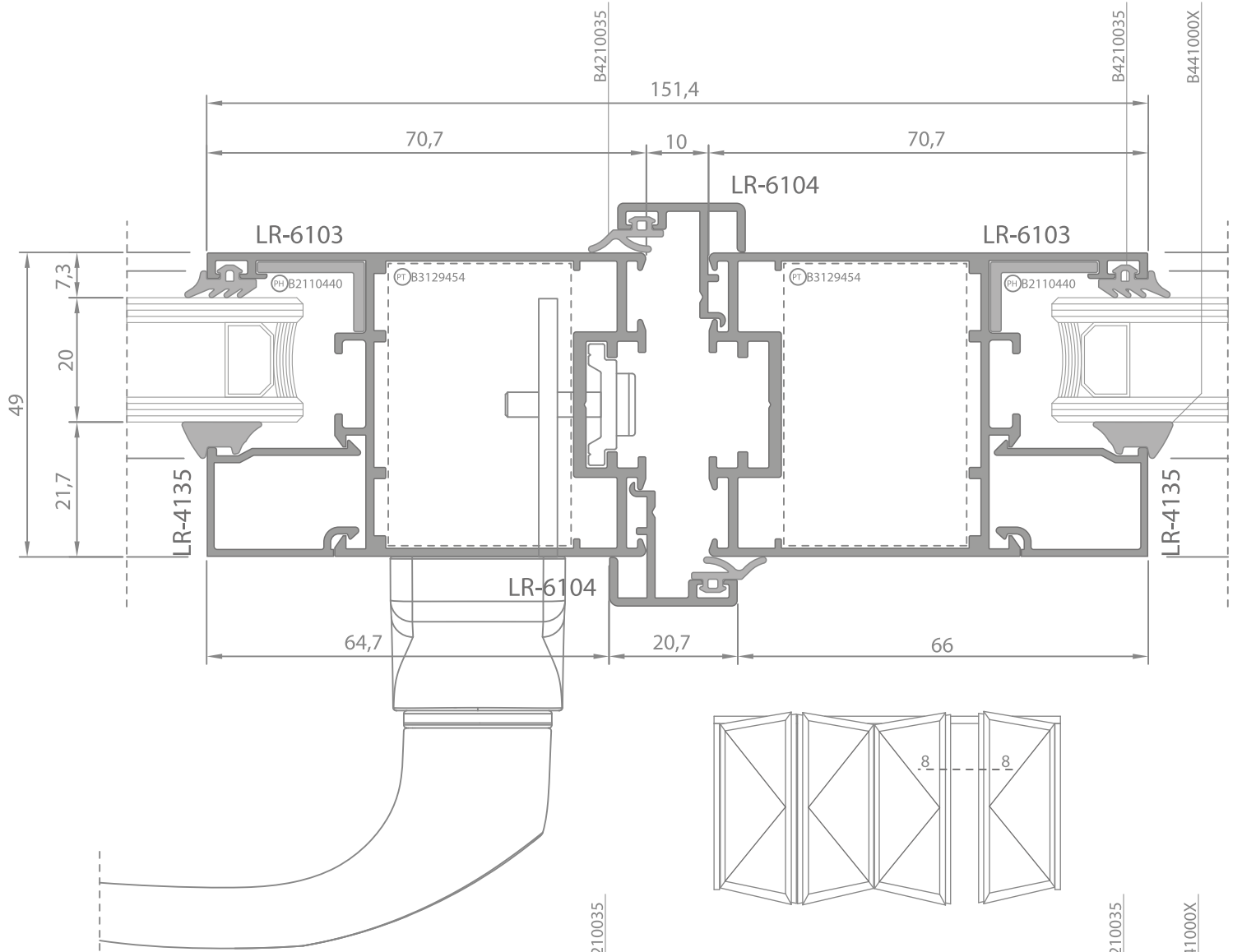
8.8 Detayı
DetailsÖlçek: 1:1
Scale: 1:1

LR6100 serisinin tüm fikri ve sınai hakları tescillidir, kopyalanamaz. / All intellectual and industrial property rights of LR6100 series are copyrighted.

Profil ağırlıklarımız teorik ağırlıklardır, üretim sonrası tartı ağırlığı geçerli olacaktır. / The weight values of profiles are theoretical. Weighting after production is valid.

SAYFA 00

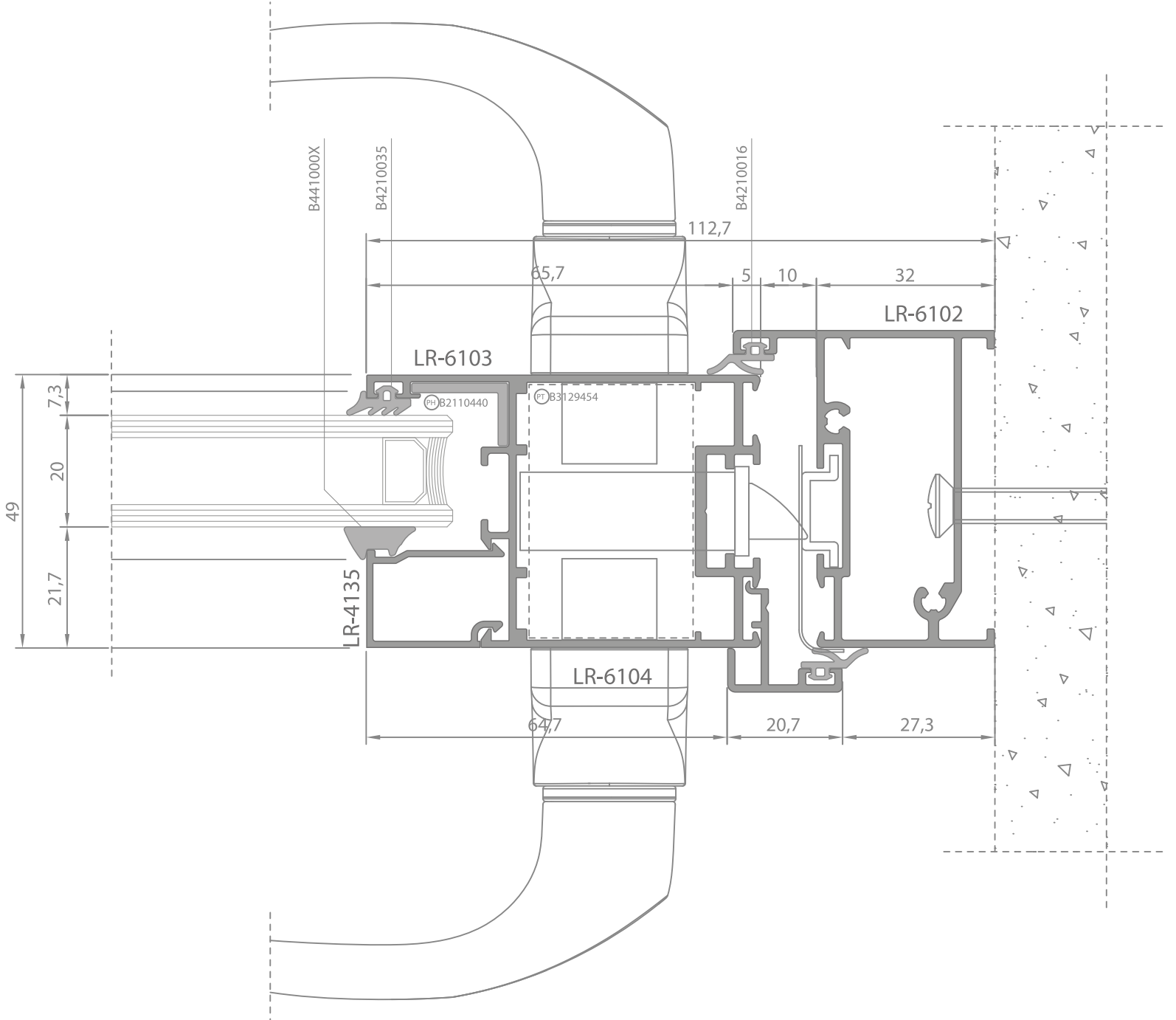
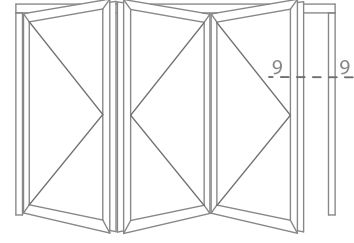

9.9 Detayı Details

LR6100 serisinin tüm fikri ve sınai hakları tescillidir, kopyalanamaz. / All intellectual and industrial property rights of LR6100 series are copyrighted.

Profil ağırlıklarımız teorik ağırlıklardır, üretim sonrası tartı ağırlığı geçerli olacaktır. / The weight values of profiles are theoretical. Weighting after production is valid.

Ölçek: 1:1
Scale: 1:1

SAYFA 00

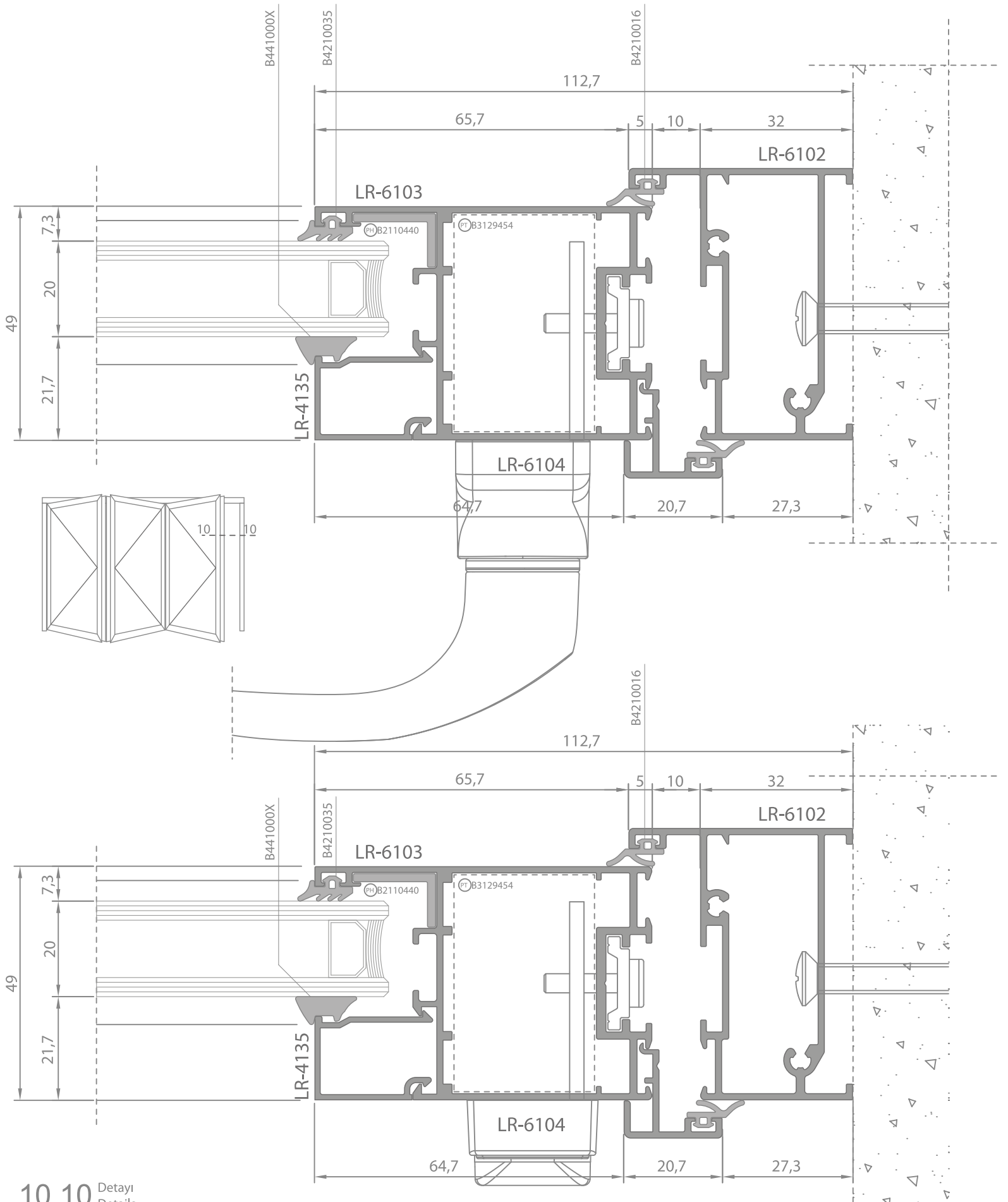
10.10 Detayı
Details

LR6100 serisinin tüm fikri ve sınai hakları tescillidir, kopyalanamaz. / All intellectual and industrial property rights of LR6100 series are copyrighted.

Profil ağırlıklarımız teorik ağırlıklardır, üretim sonrası tartı ağırlığı geçerli olacaktır. / The weight values of profiles are theoretical. Weighting after production is valid.

Ölçek: 1:1
SAYFA 00

90° Kanat Açılım Tipleri

90° Types of Opening

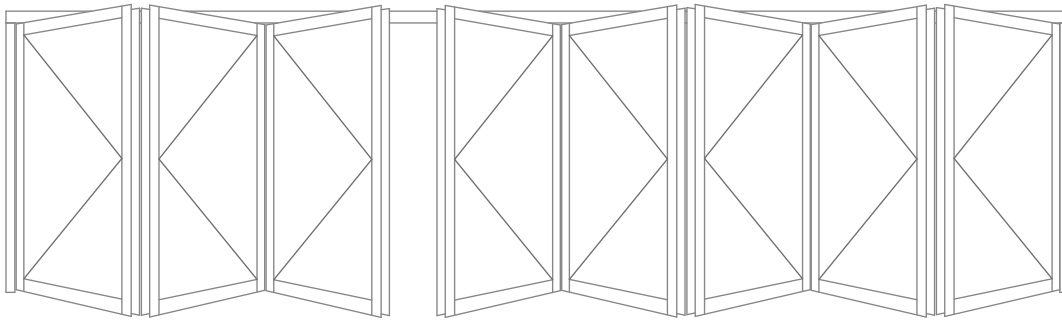
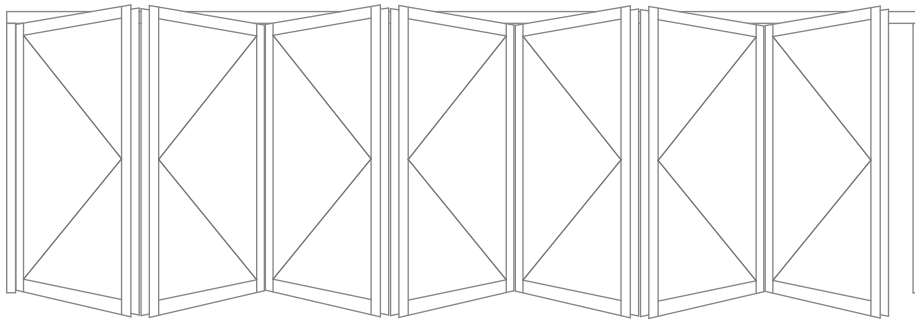
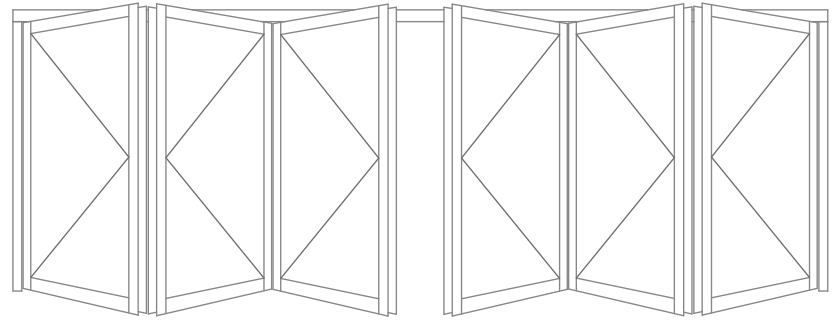
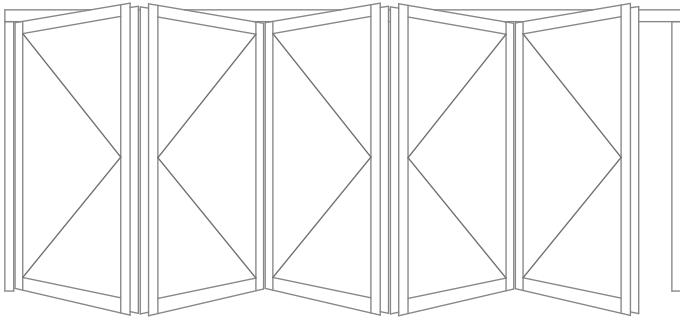
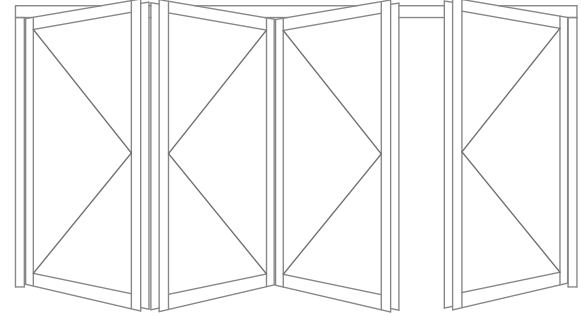
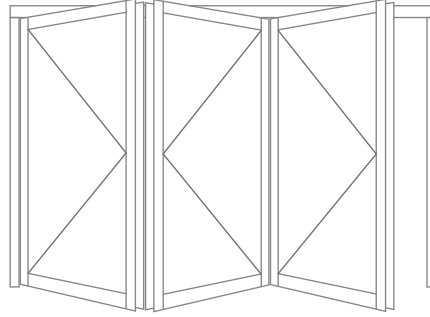
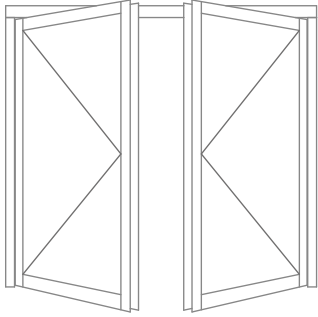

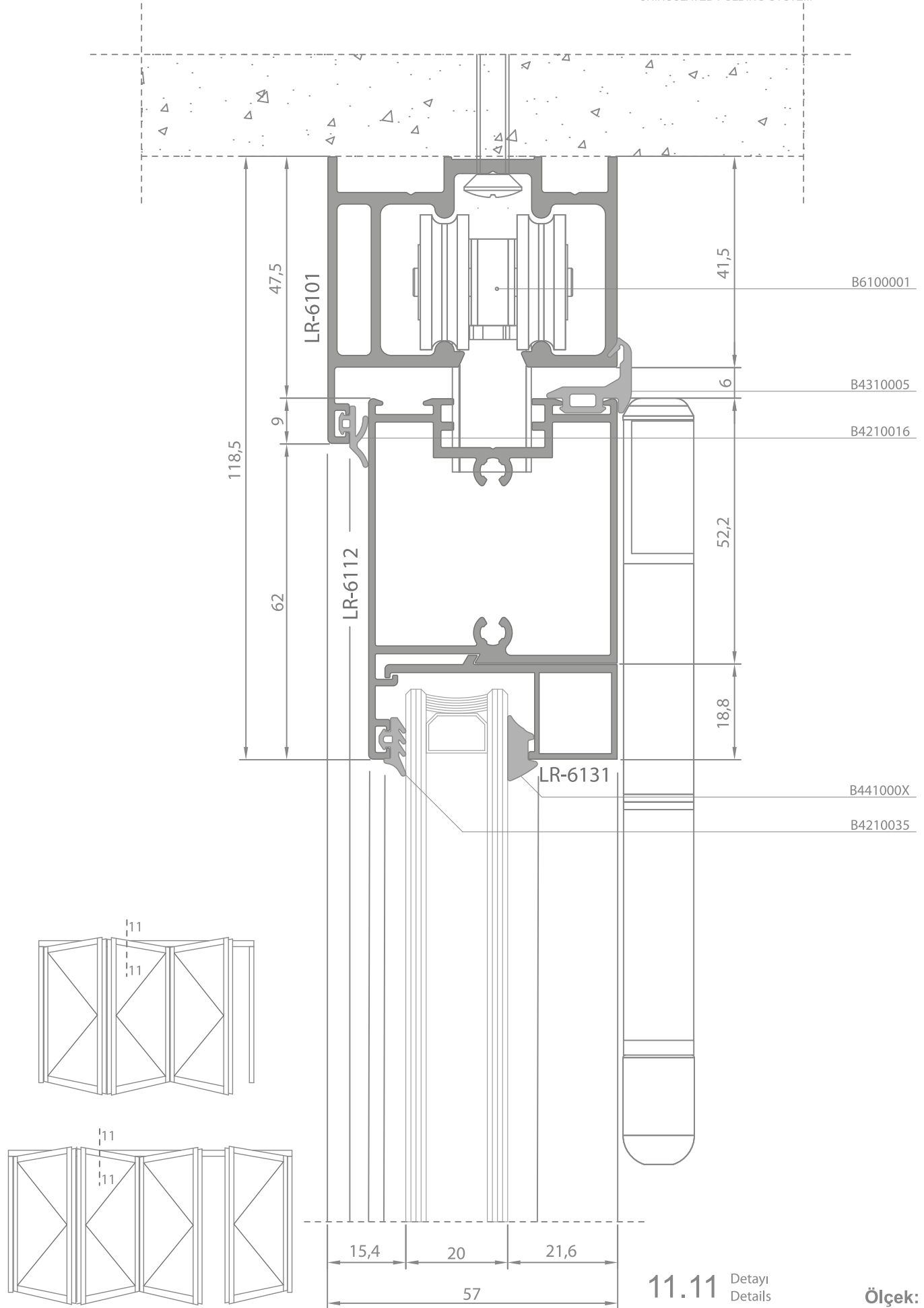
11.11 Detayı
DetailsÖlçek: 1:1
Scale: 1:1

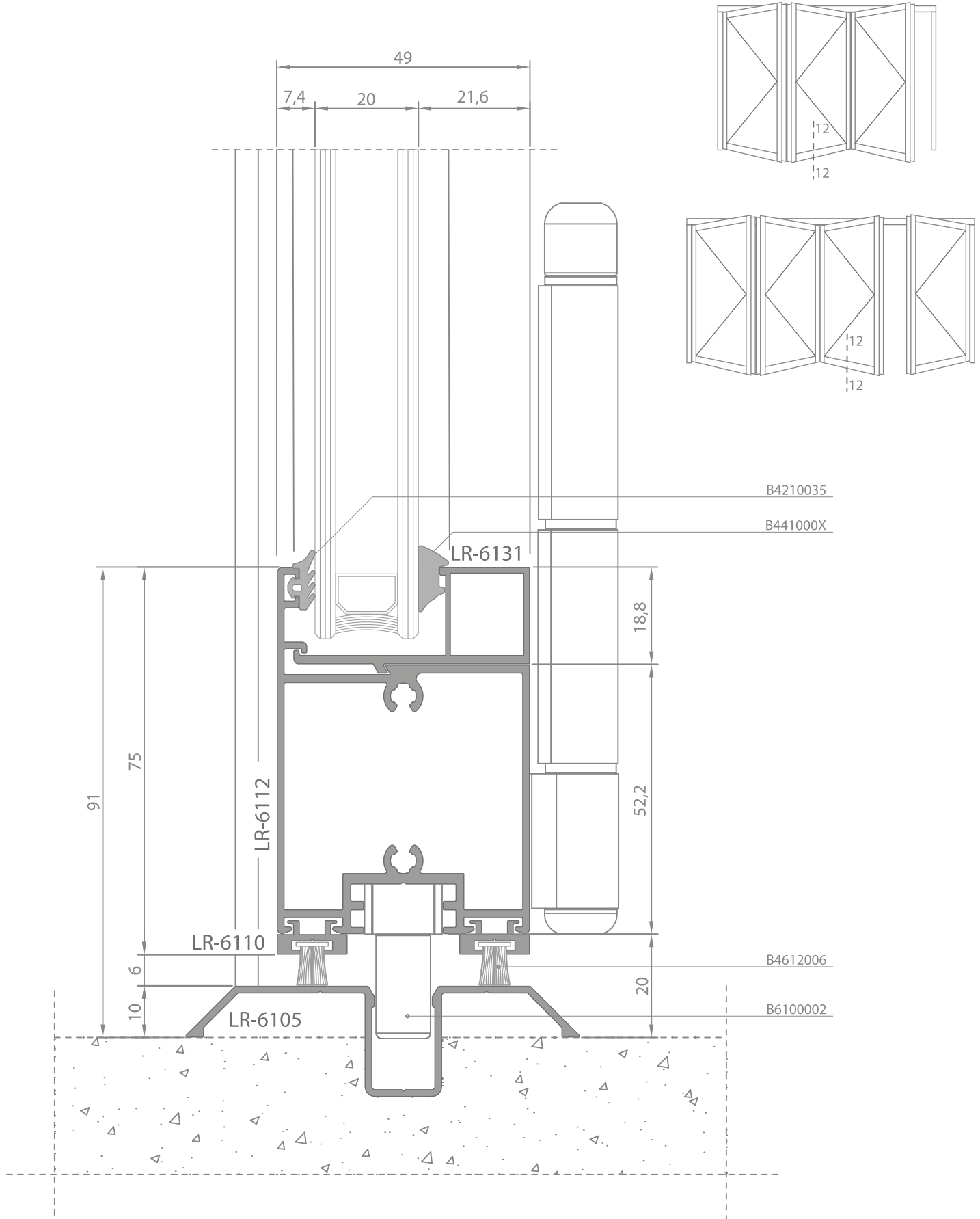

12.12 Detayı Details

LR6100 serisinin tüm fikri ve sınai hakları tescillidir, kopyalanamaz. / All intellectual and industrial property rights of LR6100 series are copyrighted.

Profil ağırlıklarımız teorik ağırlıklardır, üretim sonrası tartı ağırlığı geçerli olacaktır. / The weight values of profiles are theoretical. Weighting after production is valid.

Ölçek: 1:1
Scale: 1:1

SAYFA 00

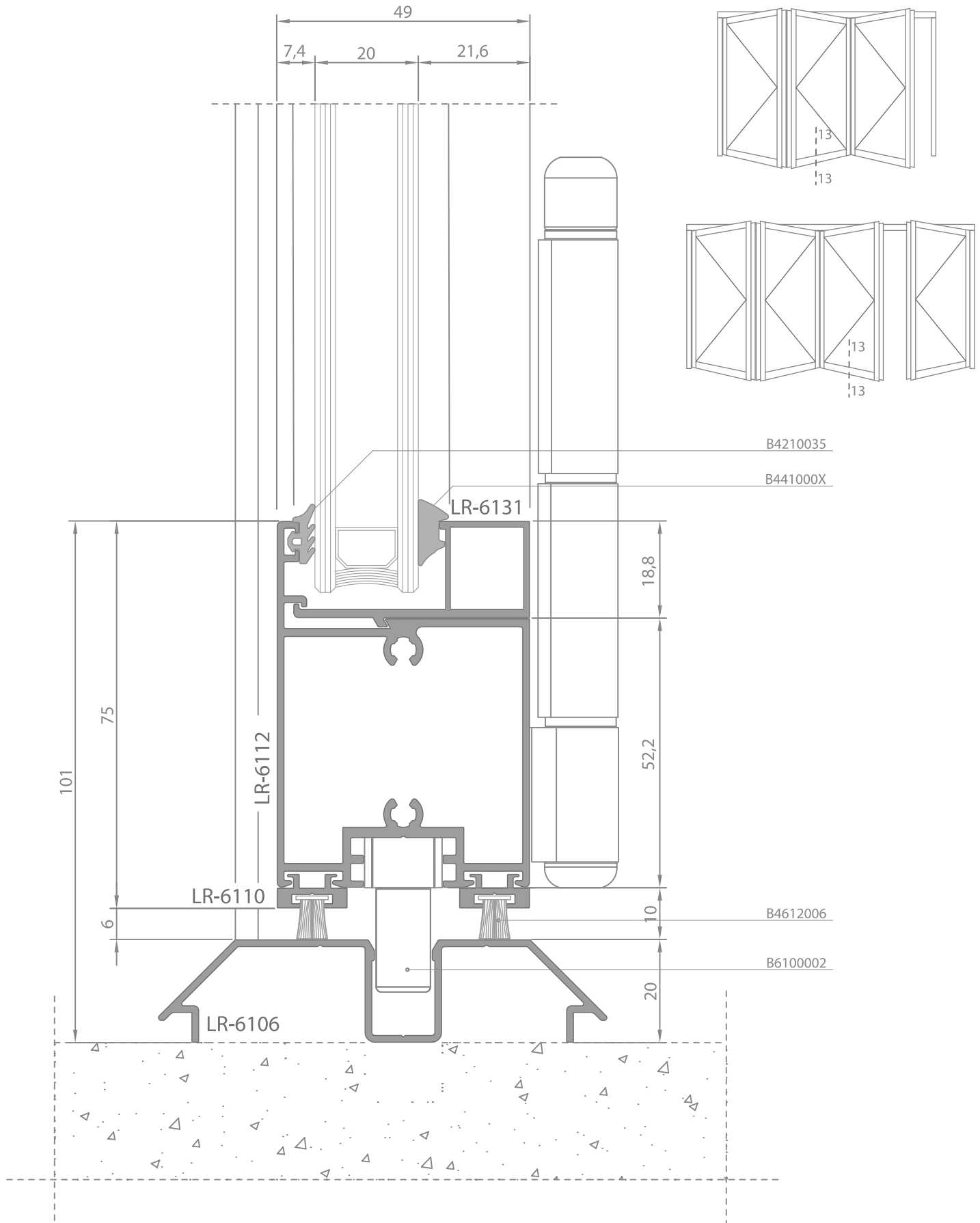

13.13 Detayı Details

LR6100 serisinin tüm fikri ve sınai hakları tescillidir, kopyalanamaz. / All intellectual and industrial property rights of LR6100 series are copyrighted.

Profil ağırlıklarımız teorik ağırlıklardır, üretim sonrası tartı ağırlığı geçerli olacaktır. / The weight values of profiles are theoretical. Weighting after production is valid.

Ölçek: 1:1
Scale: 1:1

SAYFA 00

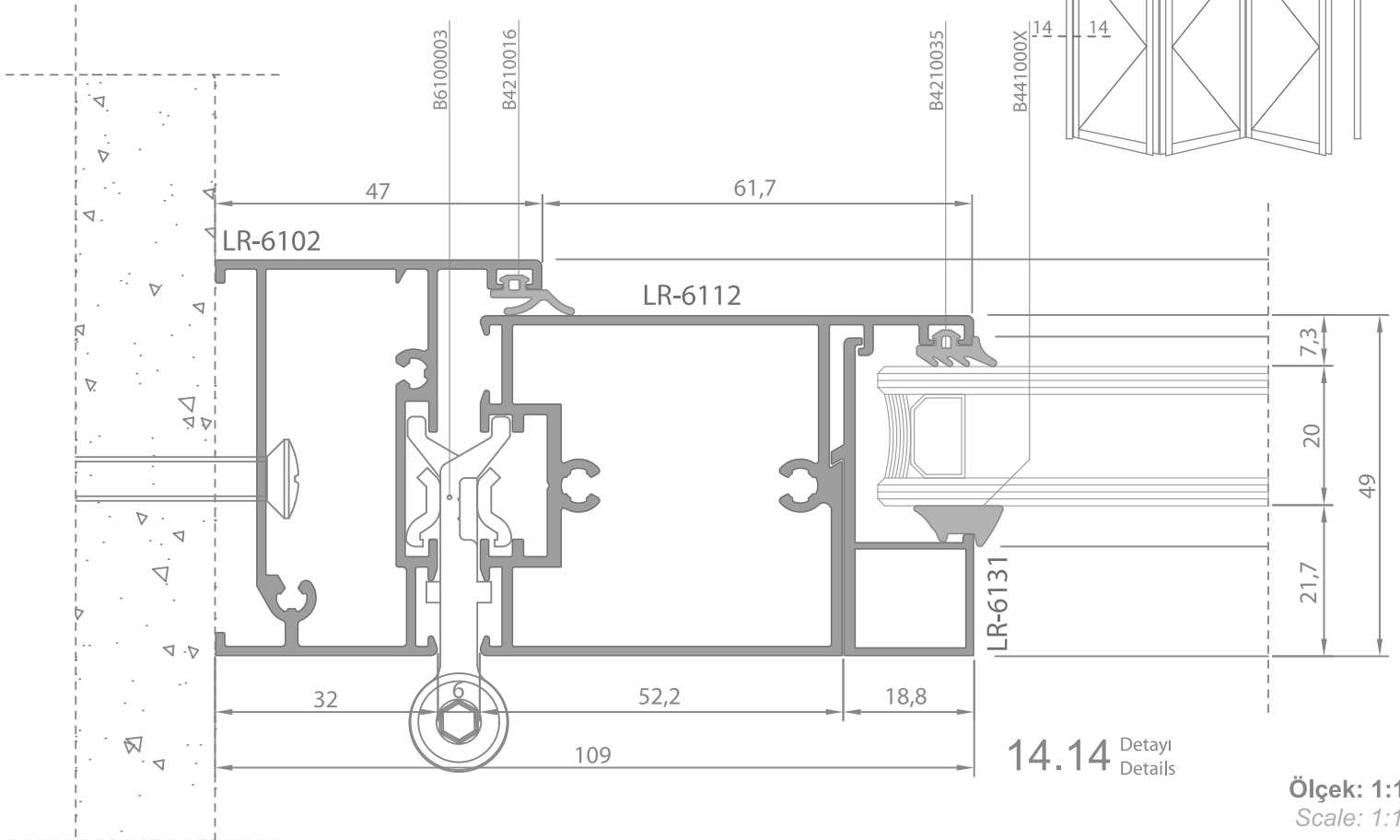
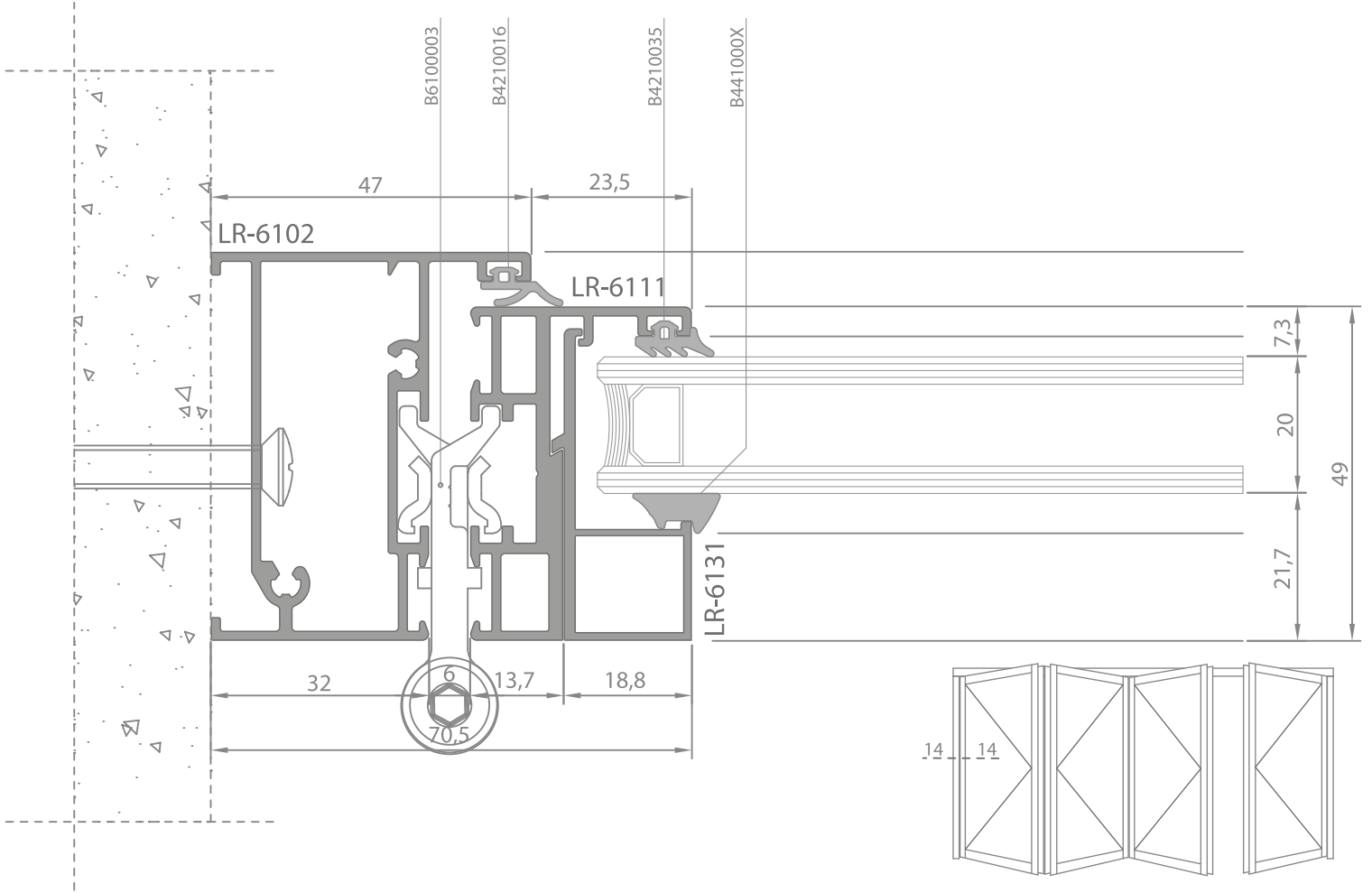

14.14 Detaylı
Details

Ölçek: 1:1
Scale: 1:1

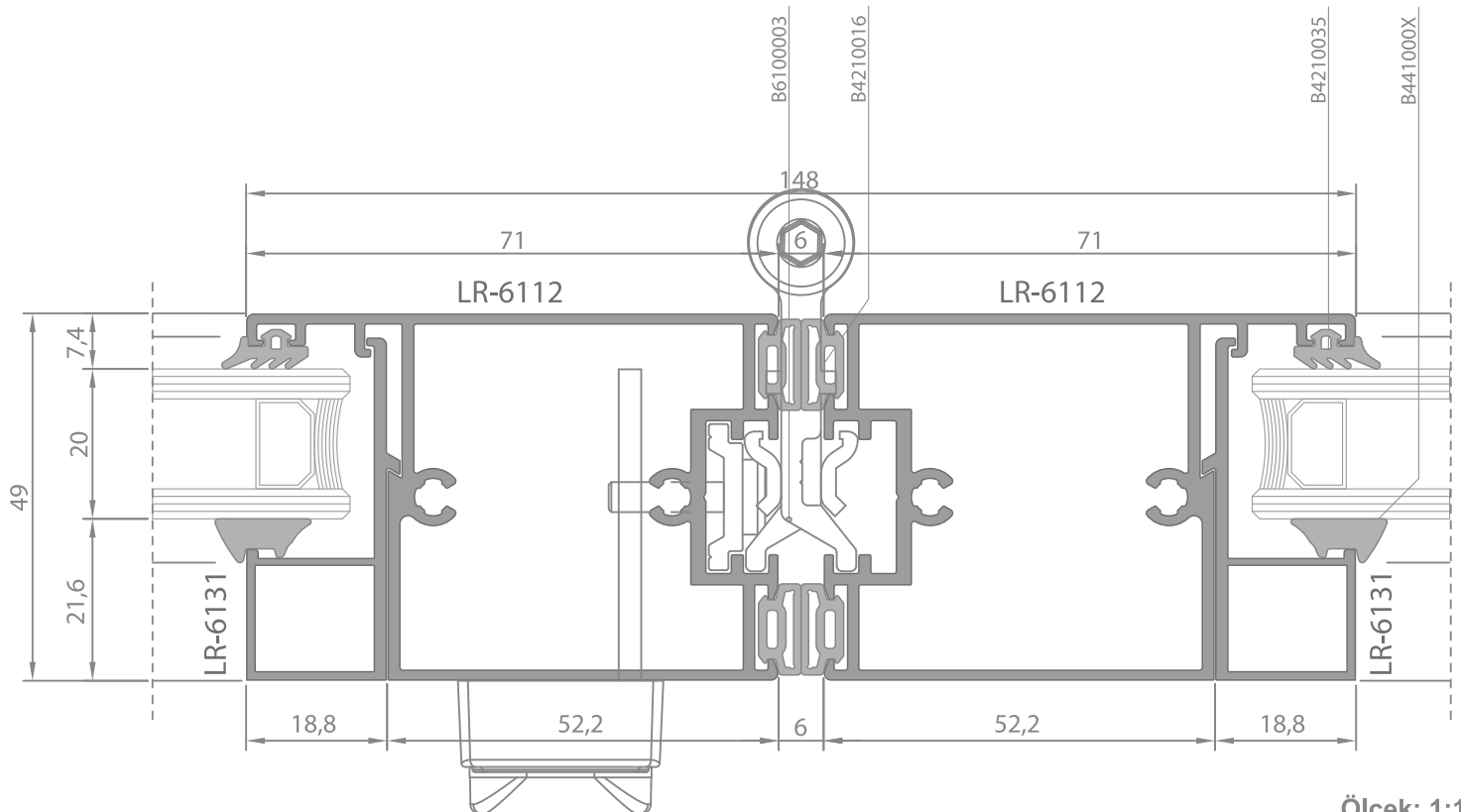
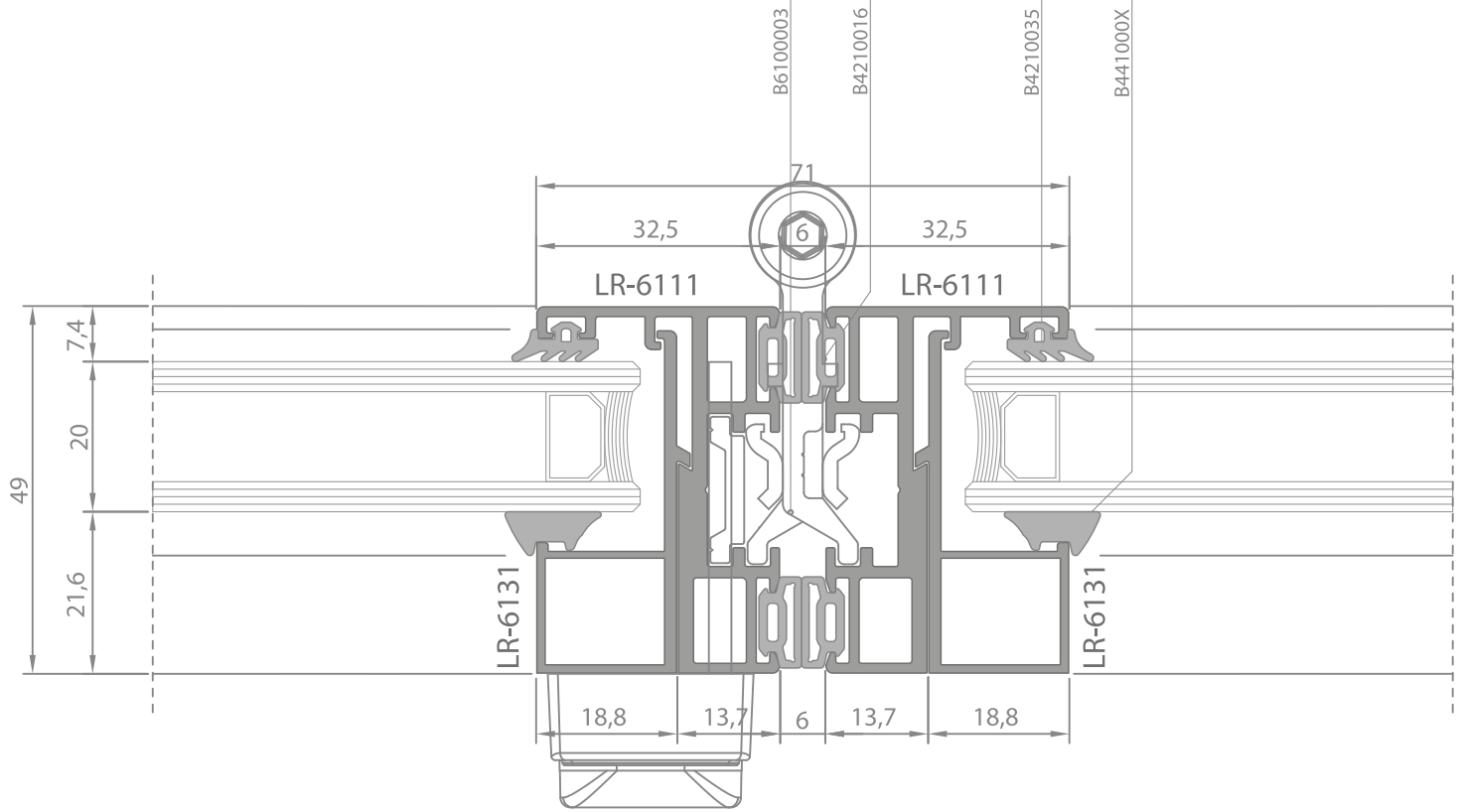
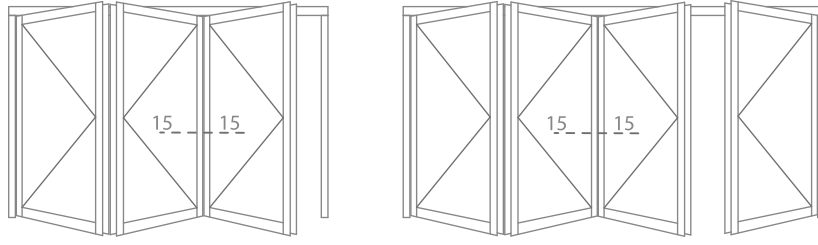

Ölçek: 1:1
Scale: 1:1

LR6100 serisinin tüm fikri ve sınai hakları tescillidir, kopyalanamaz. / All intellectual and industrial property rights of LR6100 series are copyrighted.

Profil ağırlıklarımız teorik ağırlıklardır, üretim sonrası tartı ağırlığı geçerli olacaktır. / The weight values of profiles are theoretical. Weighting after production is valid.

SAYFA 00

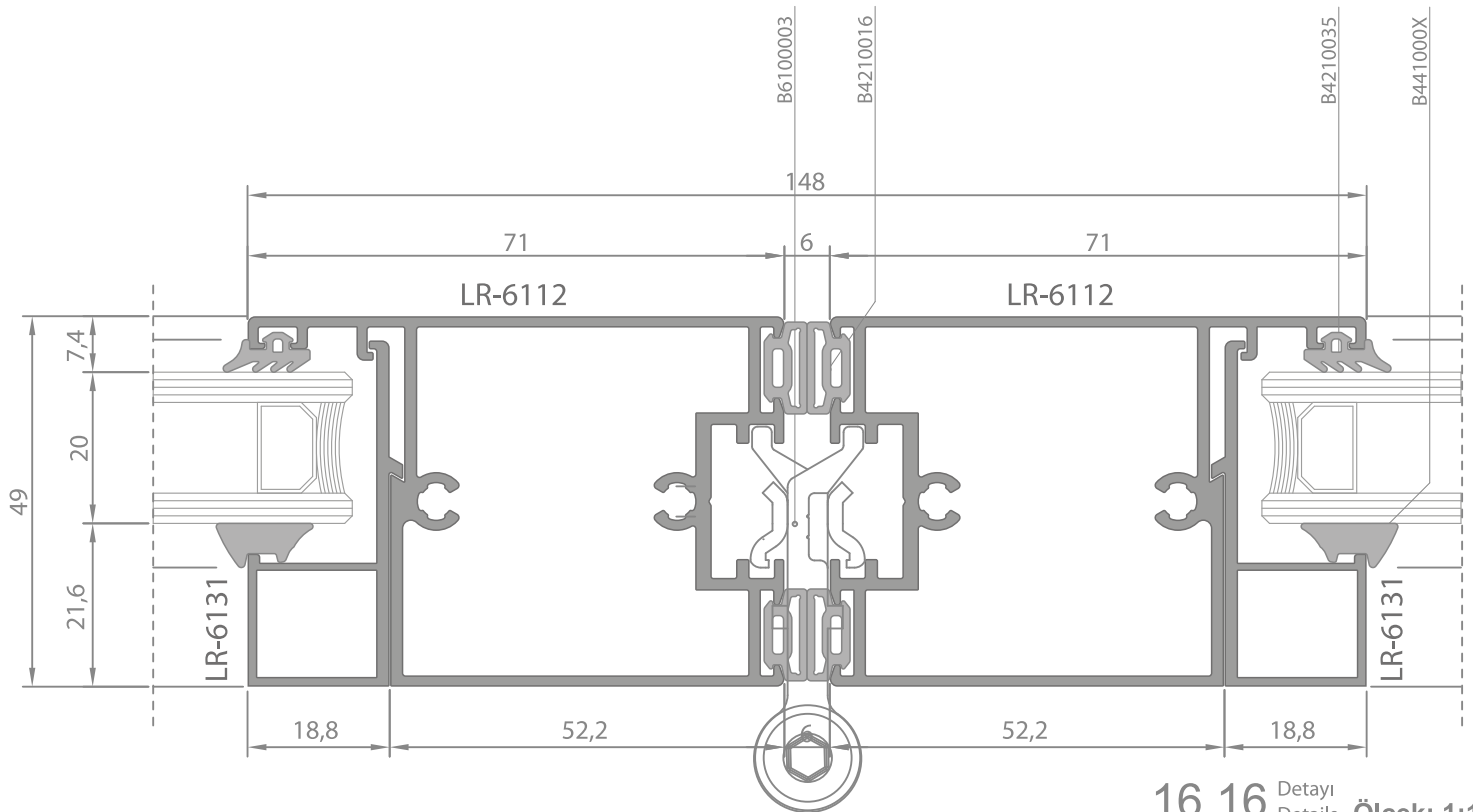
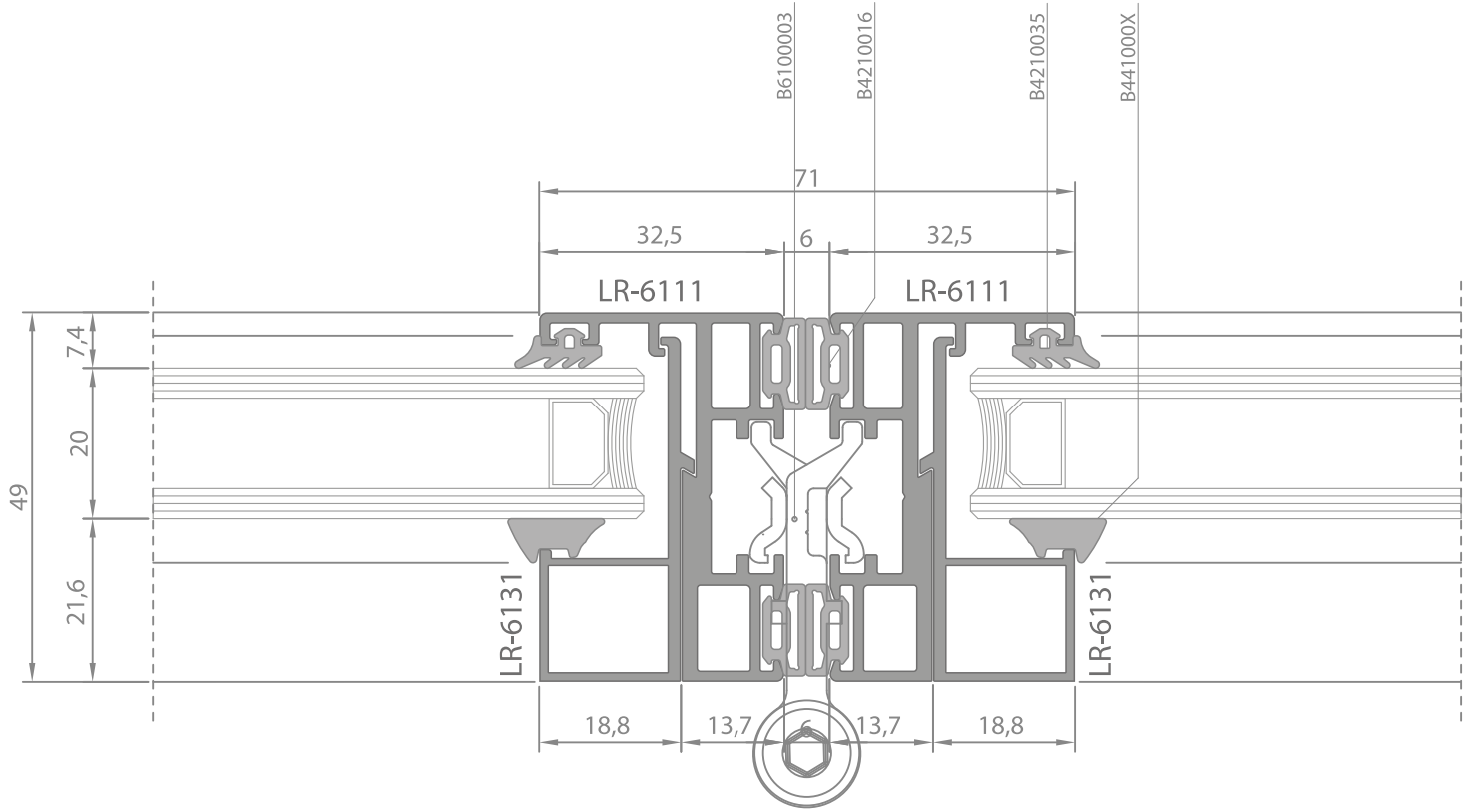
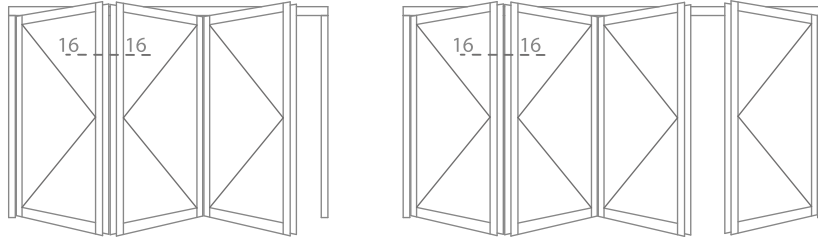

16.16 Detay
Details

Ölçek: 1:1
Scale: 1:1

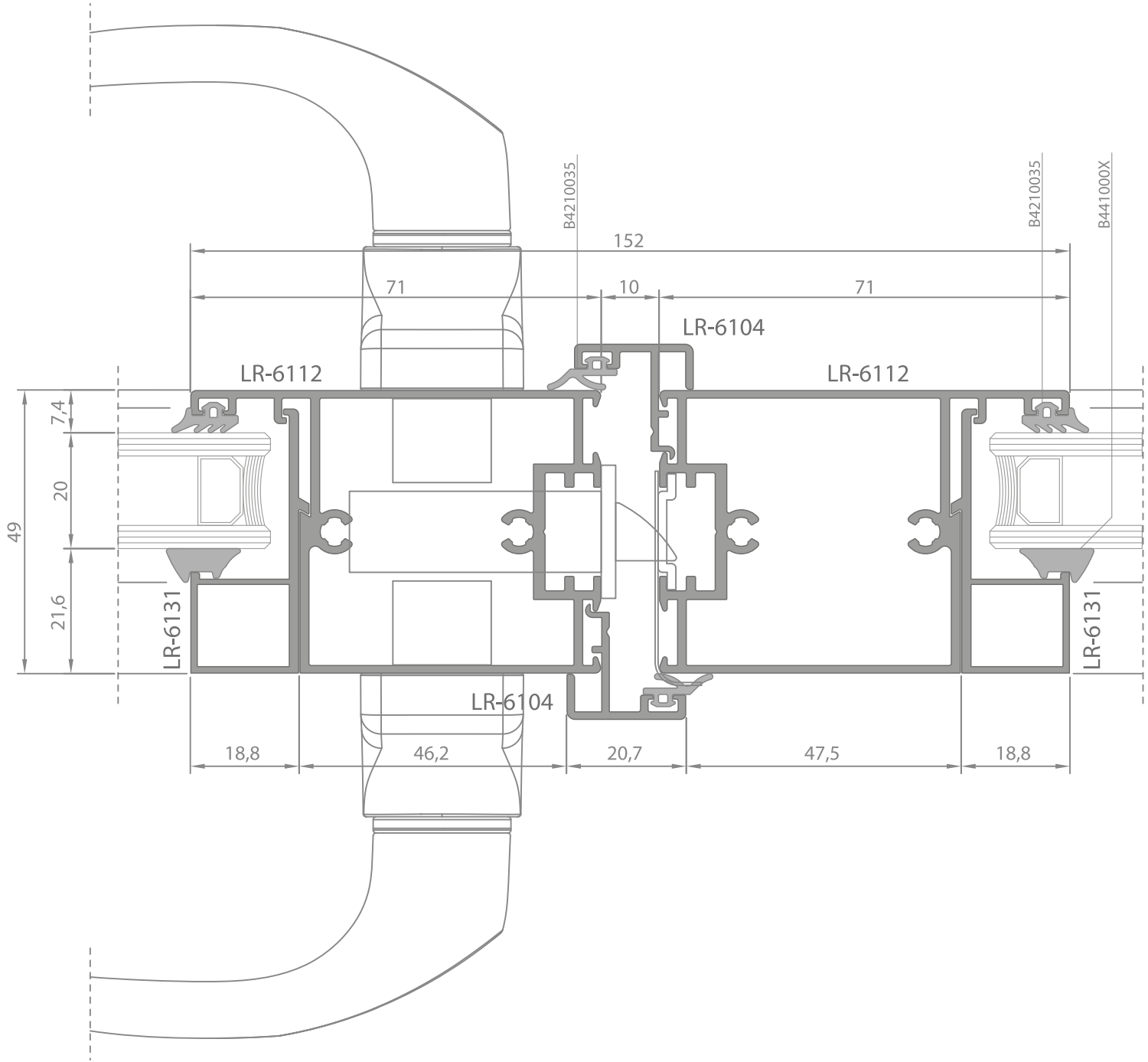
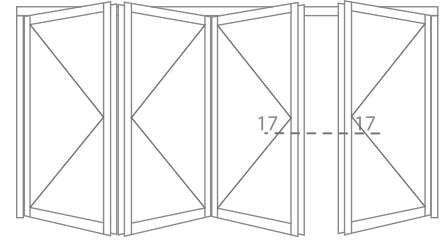

17.17 Detayı Details

LR6100 serisinin tüm fikri ve sınai hakları tescillidir, kopyalanamaz. / All intellectual and industrial property rights of LR6100 series are copyrighted.

Profil ağırlıklarımız teorik ağırlıklardır, üretim sonrası tartı ağırlığı geçerli olacaktır. / The weight values of profiles are theoretical. Weighting after production is valid.

Ölçek: 1:1

Scale: 1:1

SAYFA 00

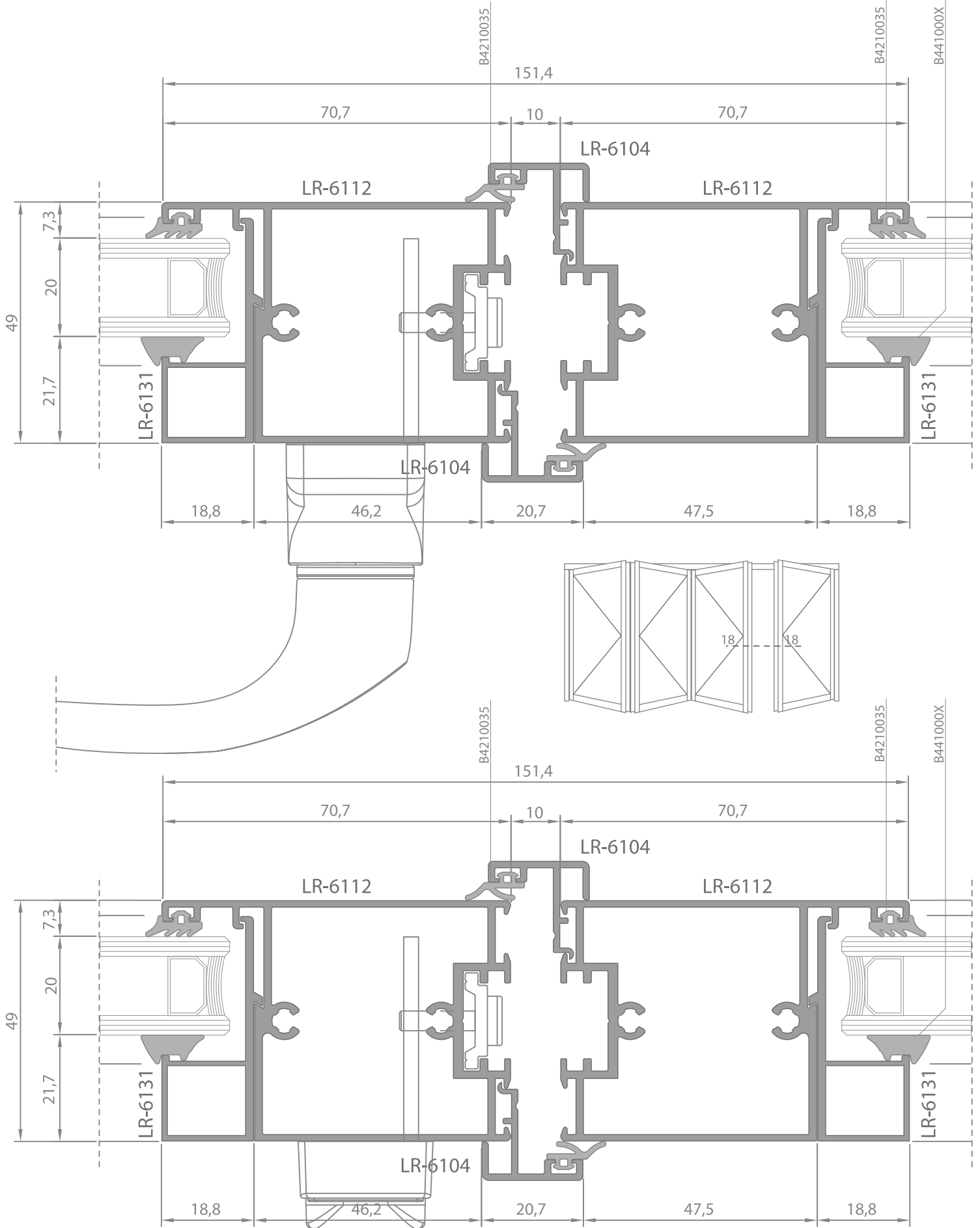

18.18 Detayı Details

LR6100 serisinin tüm fikri ve sınai hakları tescillidir, kopyalanamaz. / All intellectual and industrial property rights of LR6100 series are copyrighted.

Profil ağırlıklarımız teorik ağırlıklardır, üretim sonrası tartı ağırlığı geçerli olacaktır. / The weight values of profiles are theoretical. Weighting after production is valid.

Ölçek: 1:1

Scale: 1:1

SAYFA 00

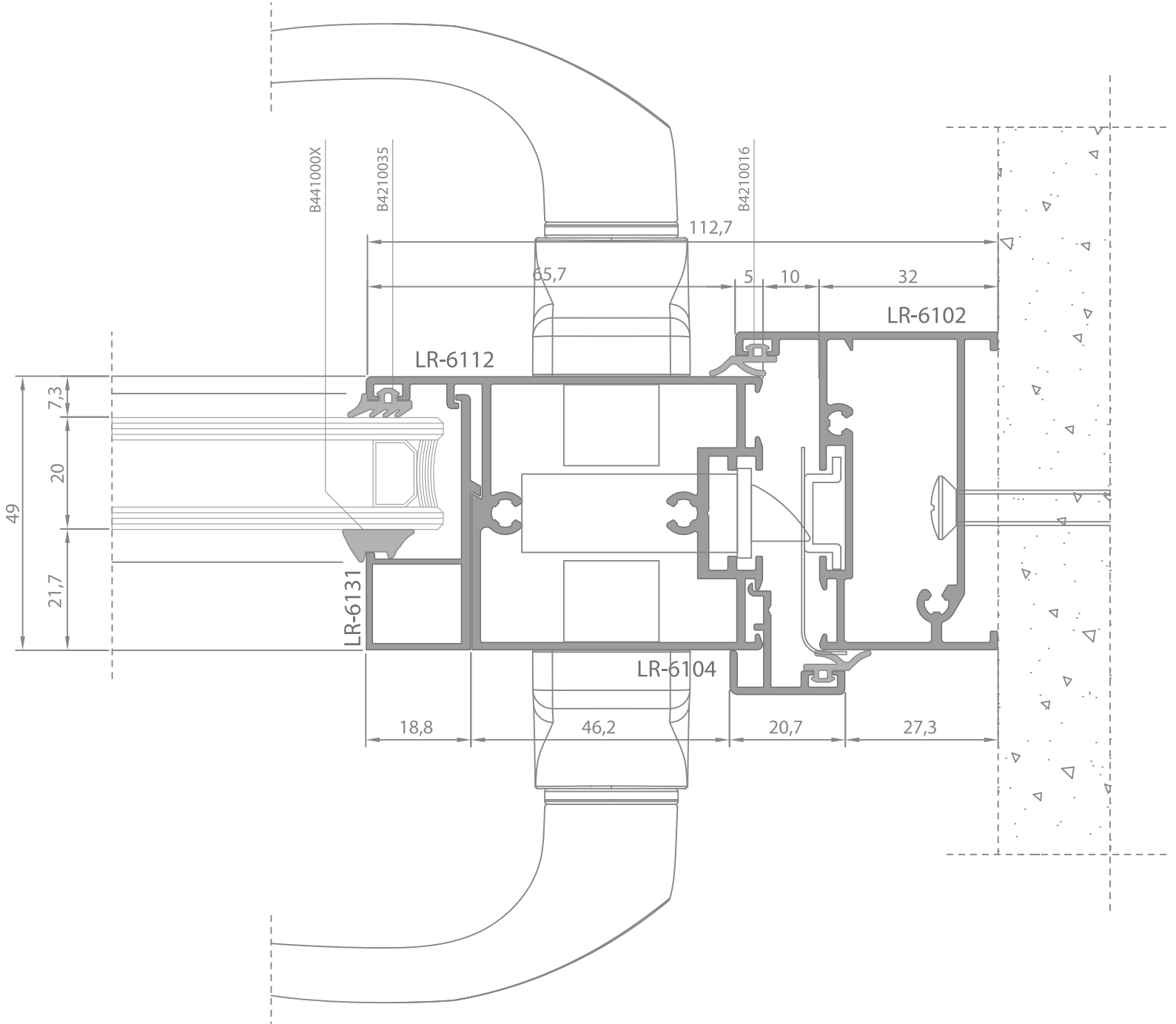
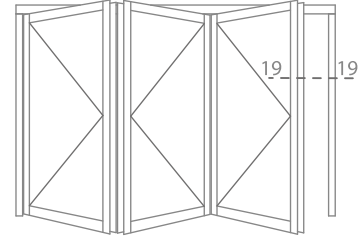

19.19 Detayı Details

LR6100 serisinin tüm fikri ve sınai hakları tescillidir, kopyalanamaz. / All intellectual and industrial property rights of LR6100 series are copyrighted.

Profil ağırlıklarımız teorik ağırlıklardır, üretim sonrası tartı ağırlığı geçerli olacaktır. / The weight values of profiles are theoretical. Weighting after production is valid.

Ölçek: 1:1
Scale: 1:1

SAYFA 00

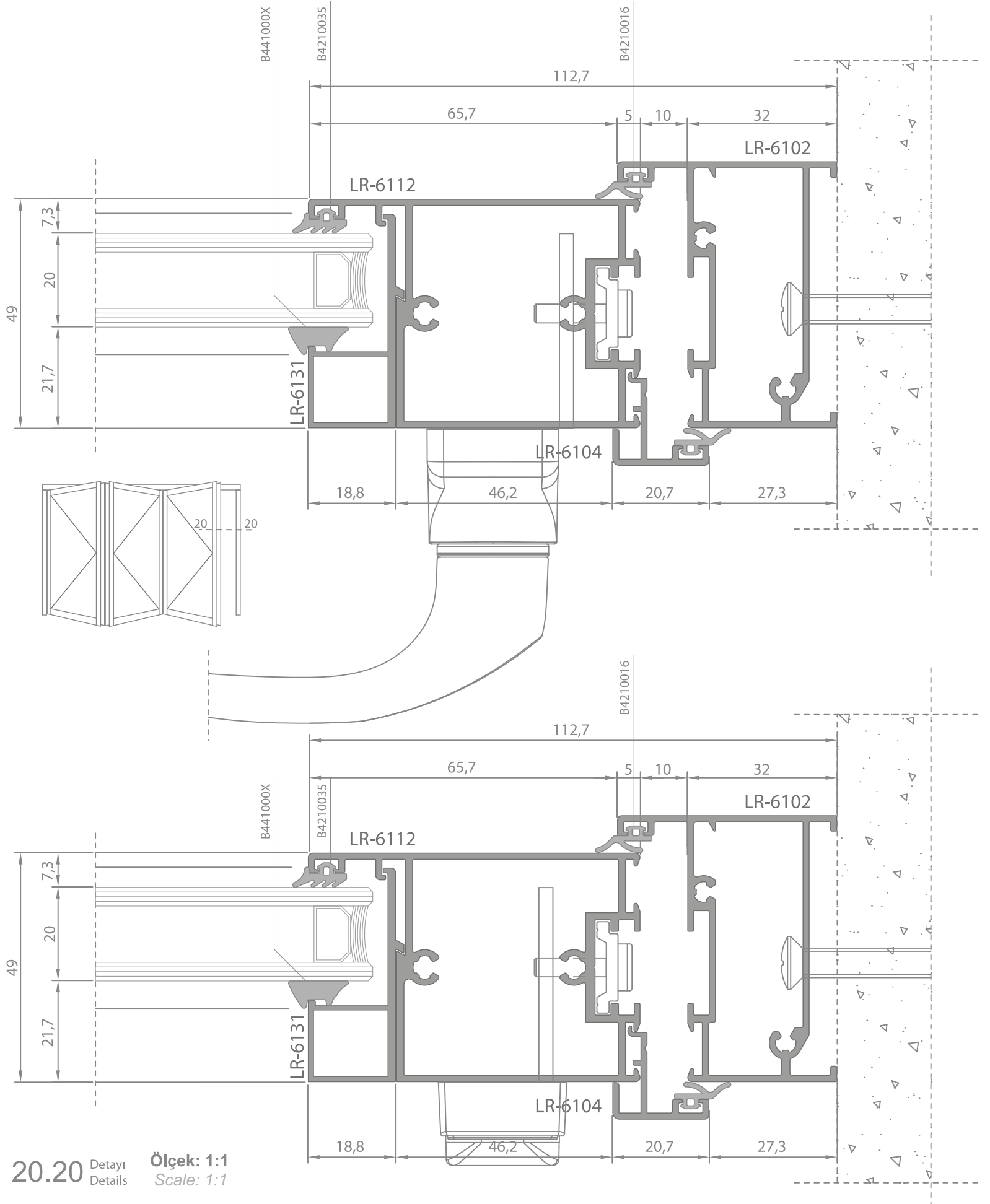
20.20 Detay
DetailsÖlçek: 1:1
Scale: 1:1